

**ORDER: ACCEPT REVISED PROGRAM FOR SAP-36(20)S-CR 313, 102 AND 215**

Motion was made by Brent Larson, duly seconded by Chad McLarty, to accept revised program for SAP-36(20)S- CR 313, 102 and 215.

The vote on the motion was as follows:

Supervisor Brent Larson, voted yes  
Supervisor Larry Gillespie, absent  
Supervisor David Rikard, voted yes  
Supervisor Chad McLarty, voted yes  
Supervisor Mike Roberts, voted yes

After the vote, President Roberts, declared the motion carried, this the 17<sup>th</sup> day of July, 2023.

  
\_\_\_\_\_  
Mike Roberts, President  
Board of Supervisors

  
\_\_\_\_\_  
Sherry Wall, Chancery Clerk

Revised

State Aid Program for Lafayette County

PROJECT PRIORITY NO.

1. Project No. SAP-36(20) S REV
2. Name of Road: See Attachment
3. Design Classification: (check one) Rural ☐ Urban ☐ (check one) Collector ☐ Local ☐  
Federal Route Number See Attachment
4. Termini of Project: See Attachment
5. Length of Project: 24.960 (See Attachment) Miles
6. Character of Work (Show Alternates if Applicable) Base Repair, Leveling, Micro-Seal Striping and Signing
7. Design Data:
  - a. Traffic Count: How Determined See Attachment for all of Section 7  
Current ADT          VPD; Design Year ADT          VPD; %Trucks           
Traffic Count Required: Yes ☐ No ☐ (Attach Supplemental Sheet)
  - b. Terrain Level          Rolling          Design Speed          MPH
  - c. ROW: Existing          Ft.; Proposed          Ft.
  - d. Proposed Roadway Crown Width          Ft.
  - e. Surface Type & Width: Existing          Ft.  
Proposed          Ft.
8. Bridges:
  - a. Str. No. See Attachment Suff. Rtg.          Capacity           
Remain in Place: Yes ☐ No ☐ Existing/Proposed Width          Ft.
  - b. Str. No.          Suff. Rtg.          Capacity           
Remain in Place: Yes ☐ No ☐ Existing/Proposed Width          Ft.
  - c. Str. No.          Suff. Rtg.          Capacity           
Remain in Place: Yes ☐ No ☐ Existing/Proposed Width          Ft.
  - d. Str. No.          Suff. Rtg.          Capacity           
Remain in Place: Yes ☐ No ☐ Existing/Proposed Width          Ft.
  - e. Str. No.          Suff. Rtg.          Capacity           
Remain in Place: Yes ☐ No ☐ Existing/Proposed Width          Ft.
9. Estimated Construction Cost of Project (Including Contingencies) \$ 2,942,600.00
  - a. STP Funds Requested (          %) \$
  - b. BR Funds Requested (          %) \$
  - c. SA Funds Requested ( 100 %) \$ 2,442,600.00
  - d. LSBP Funds (          %) \$
  - e. County Funds \$ 500,000.00

Engineering Cost ( 12 % ) (Constr. Cost Less Contingencies) \$ 336,300.00

  - a. State Aid Funds Requested \$ 336,300.00
  - b. County Funds Contributed \$
  - c. LSBP Funds Contributed \$
  - d.          Funds Contributed \$

Total Estimated Cost of Project \$ 3,278,900.00

Construction will be by: Contract ☒ County Forces ☐

Use Supplemental Sheet and/or maps if needed to provide complete data.

FOR STATE AID USE ONLY:

Preliminary Review	_____	Date
Recommend Approval	_____ Dist. Engr.	Date
Approved	_____ State Aid Engr.	Date
Letter To Bd.	_____ Dist. Engr.	Date
Funds Record	_____ Auditor	Date
Programmed	_____	Date

State Aid Program for Lafayette County

BOARD OF SUPERVISORS

\_\_\_\_\_, County  
\_\_\_\_\_, Supervisor, District I  
\_\_\_\_\_, Supervisor, District II  
\_\_\_\_\_, Supervisor, District III  
\_\_\_\_\_, Supervisor, District IV  
\_\_\_\_\_, Supervisor, District V

Prepared by: \_\_\_\_\_, County Engineer

STATE OF MISSISSIPPI  
COUNTY OF Lafayette

This is to certify that the foregoing is a true and correct copy of an order passed by the Board of Supervisors of Lafayette County, Mississippi, entered into the minutes of the said Board of Supervisors, Minute Book No. \_\_\_\_\_, Page No. \_\_\_\_\_, same having been adopted at a meeting of said Board of Supervisors on the \_\_\_\_\_ day of \_\_\_\_\_,

\_\_\_\_\_  
Clerk of Board of Supervisors of  
Lafayette County, Mississippi

**OFFICE OF STATE AID ROAD CONSTRUCTION  
MISSISSIPPI DEPARTMENT OF TRANSPORTATION  
JACKSON, MISSISSIPPI**

DATA TO BE SUBMITTED WITH ALL PROJECT PROGRAMS

Project Number SAP-36(20)S REV County Lafayette Date \_\_\_\_\_

Road Connections at each End of Project

See Attachment End, Surf. Type \_\_\_\_\_ Surf. Width \_\_\_\_\_ Rdwy. Width \_\_\_\_\_

(South or West)

See Attachment End, Surf. Type \_\_\_\_\_ Surf. Width \_\_\_\_\_ Rdwy. Width \_\_\_\_\_

(North or East)

Railroad Grade Crossing Data

Is there an existing Railroad Grade Crossing? Yes \_\_\_\_\_ No ☒

Name of Railroad N/A

Existing Protection N/A

Proposed Protection N/A

Existing and/or Proposed Facilities Effecting Route:

SCHOOLS: YES \_\_\_\_\_ NO ☒ ON ROUTE \_\_\_\_\_ OFF ROUTE \_\_\_\_\_  
INDUSTRY: YES \_\_\_\_\_ NO ☒ ON ROUTE \_\_\_\_\_ OFF ROUTE \_\_\_\_\_

TYPE OF INDUSTRY: None

OTHER DESIGN CONSIDERATIONS: County

UTILITY COMPANIES TO BE AFFECTED BY PROJECT:

NAME	STREET OR P.O. BOX ADDRESS	CITY
None in Conflict		

Signed \_\_\_\_\_  
County Engineer

## ROAD "A"

2. UNION - BURGESS ROAD

3. Design Classification: Rural - Collector  
Federal Route Number: 2845

4. Termini of Project:  
*Beginning at the B.O.P. of Project STP-2845(1)B located in Section 29, Township 9 South, Range 4 West and go north to the B.O.P. of Project SAP-36(24)M Road "A", located in Section 6, Township 9 South, Range 4 West.*

5. Length of Project: 5.216 mi.

7. Design Data:

a. Traffic Count:  
Determined By: MDOT  
Current ADT 1100 VPD; Design Year ADT 1430 VPD; % Trucks 10

b. Design Speed: 35 M.P.H

c. ROW: Existing N/A Ft.; Proposed N/A Ft.

b. ~~Proposed~~ Roadway Crown Width 30 Ft.  
Existing

e. Surface Type & Width:

Existing Asphalt 20 FT.  
Proposed Micro-Seal 20 FT.

8. Bridges:

a. Str. No. SA4700000000199 Suff Rtg. 99.0 Capacity 40 tons  
Remain in Place: Yes Existing Width 28 Ft.  
a. Str. No. \_\_\_\_\_ Suff Rtg. \_\_\_\_\_ Capacity \_\_\_\_\_  
Remain in Place: \_\_\_\_\_ Width \_\_\_\_\_ Ft.  
a. Str. No. \_\_\_\_\_ Suff Rtg. \_\_\_\_\_ Capacity \_\_\_\_\_  
Remain in Place: \_\_\_\_\_ Width \_\_\_\_\_ Ft.

Road Connections at each End of Project:

South End, Surf.Type Asphalt Surf.Width 20' Rdwy.Width 30'  
North End, Surf.Type Asphalt Surf.Width 20' Rdwy.Width 30'

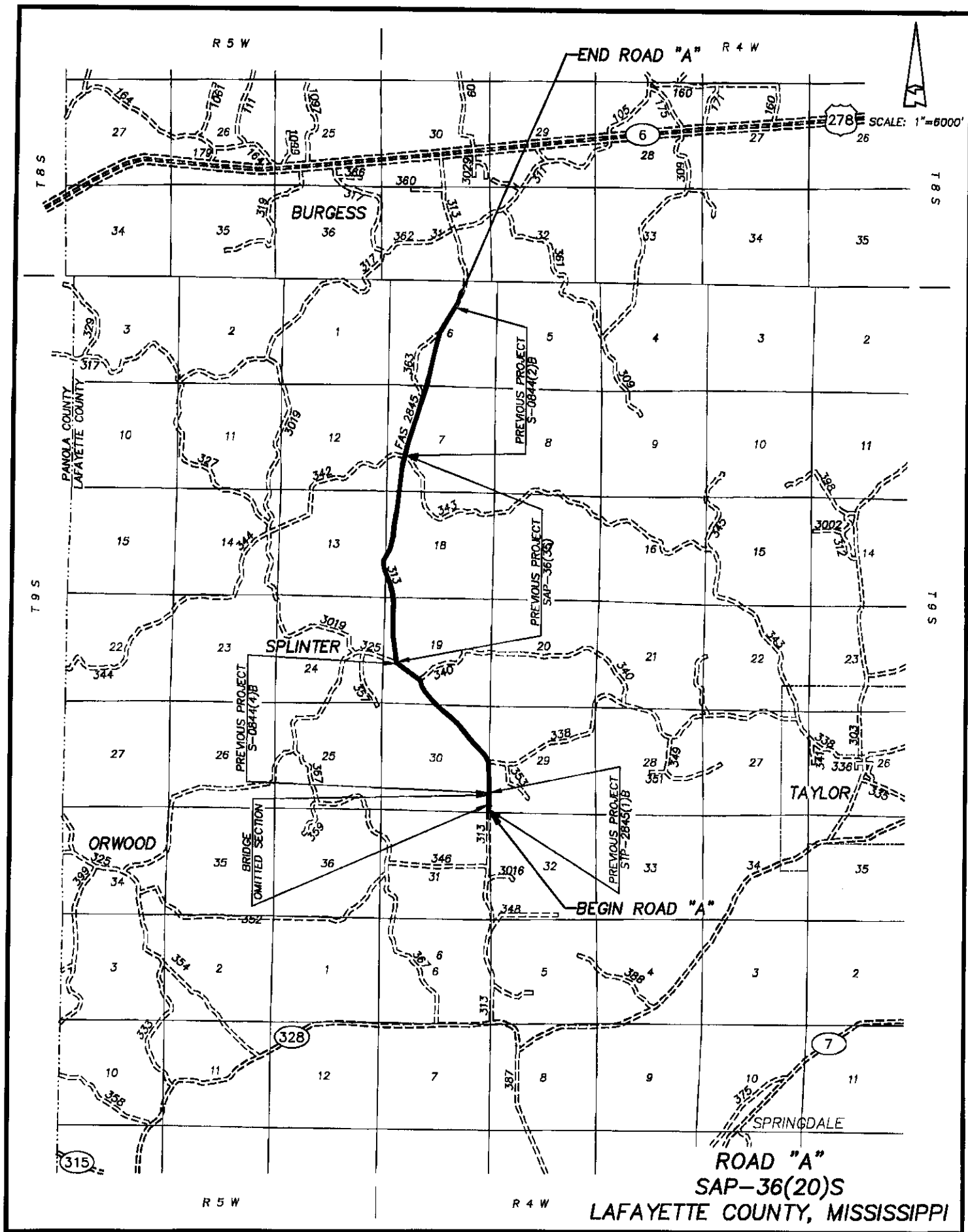

## ROAD "B"

### 2. COONTOWN ROAD

3. Design Classification: Rural - Collector  
Federal Route Number: N/A

4. Termini of Project:  
*Beginning at the Sardis Reservoir Management Area Boundary located in Section 21, Township 7 South, Range 4 West and go Southeast to the intersection of County Road 103 located in Section 36, Township 7 South, Range 4 West.*

5. Length of Project: 4.722 MI.

### 7. Design Data:

a. Traffic Count:  
Determined By: MDOT  
Current ADT 460 VPD; Design Year ADT 598 VPD; % Trucks 10

b. Design Speed: 40 M.P.H

c. ROW: Existing N/A Ft.; Proposed N/A Ft.

b. ~~Proposed~~ Roadway Crown Width 30 Ft.  
Existing

e. Surface Type & Width:

Existing Asphalt 20 FT.  
Proposed Micro-Seal 20 FT.

### 8. Bridges:

a. Str. No. None Suff Rtg. \_\_\_\_\_ Capacity \_\_\_\_\_  
Remain in Place: \_\_\_\_\_ Width \_\_\_\_\_ Ft.  
a. Str. No. \_\_\_\_\_ Suff Rtg. \_\_\_\_\_ Capacity \_\_\_\_\_  
Remain in Place: \_\_\_\_\_ Width \_\_\_\_\_ Ft.  
a. Str. No. \_\_\_\_\_ Suff Rtg. \_\_\_\_\_ Capacity \_\_\_\_\_  
Remain in Place: \_\_\_\_\_ Width \_\_\_\_\_ Ft.

### Road Connections at each End of Project:

South End, Surf.Type Asphalt Surf.Width 20' Rdwy.Width 30'  
North End, Surf.Type Asphalt Surf.Width 20' Rdwy.Width 30'

R 4 W

SCALE: 1"=6000'

T 7 S

T 7 S

T 8 S

T 8 S

R 4 W

BEGIN ROAD "B"

PREVIOUS PROJECT  
APL-0036(2)B

PREVIOUS PROJECT  
APL-0036(3)B

END ROAD "B"

COLLEGE HILL

GEORGE PAT PATTERSON PKWY

ROAD "B"

SAP-36(20)S

LAFAYETTE COUNTY, MISSISSIPPI

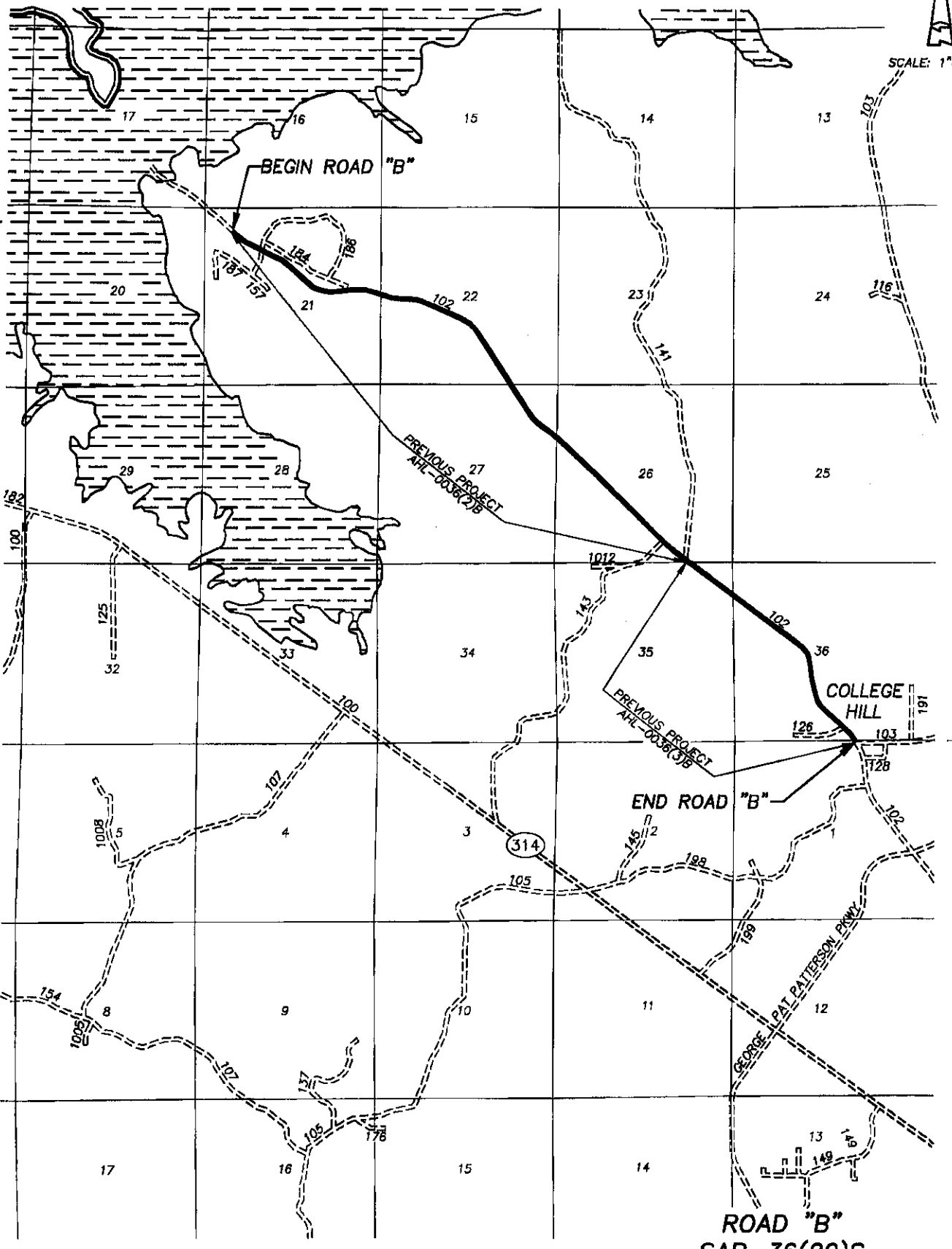

## ROAD "C"

2. WOODSON RIDGE ROAD

3. Design Classification: Rural - Collector  
Federal Route Number: N/A

4. Termini of Project:

*Beginning at the intersection of Ms. Highway No.30 located in Section 13, Township 8 South, Range 3 West and go North and West to the E.O.P. of the previous project HRRR-0036(18)B, located in Section 13, Township 7 South, Range 3 West.*

5. Length of Project: 6.786 MI.

7. Design Data:

a. Traffic Count:  
Determined By: MDOT  
Current ADT 380 VPD; Design Year ADT 494 VPD; % Trucks 10

b. Design Speed: 40 M.P.H

c. ROW: Existing N/A Ft.; Proposed N/A Ft.

b. ~~Proposed~~ Roadway Crown Width 30 Ft.  
Existing

e. Surface Type & Width:

Existing Asphalt 22 FT.  
Proposed Micro-Seal 22 FT.

8. Bridges:

a. Str. No. None Suff Rtg.        Capacity         
Remain in Place:        Width        Ft.  
a. Str. No.        Suff Rtg.        Capacity         
Remain in Place:        Width        Ft.  
a. Str. No.        Suff Rtg.        Capacity         
Remain in Place:        Width        Ft.

Road Connections at each End of Project:

South End, Surf.Type Asphalt Surf.Width 22' Rdwy.Width 30'  
North End, Surf.Type Asphalt Surf.Width 22' Rdwy.Width 30'

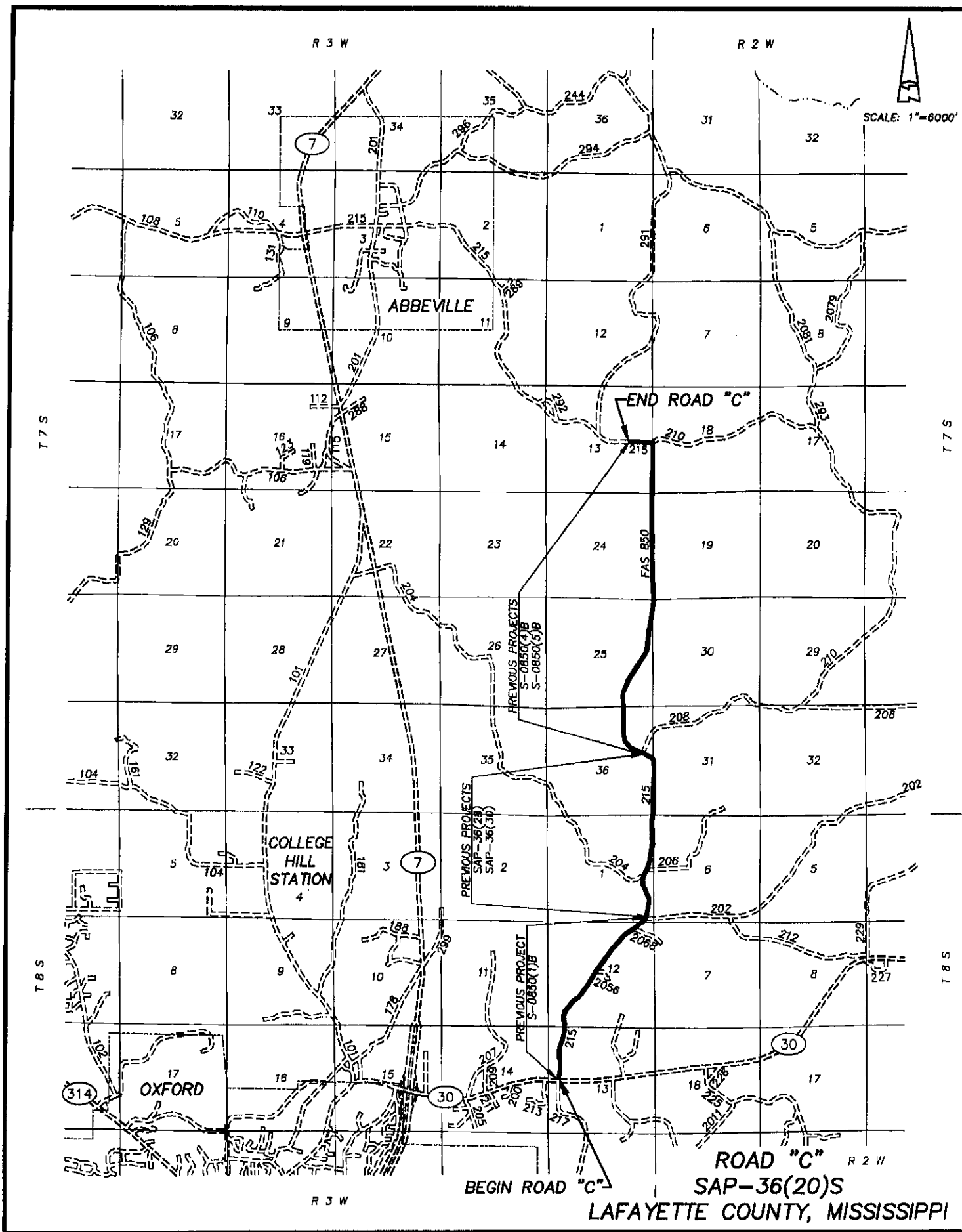

## ROAD "D"

### 2. LAFAYETTE SPRINGS ROAD

3. Design Classification: Rural - Collector  
Federal Route Number: 933

4. Termini of Project:  
*Beginning at the intersection of U.S. Highway No.278 located in Section 13, Township 8 South, Range 1 West and go North and West to the intersection of County Road No.250 located in Section 15, Township 7 South, Range 1 West.*

5. Length of Project: 8.236 mi.

### 7. Design Data:

a. Traffic Count:  
Determined By: MDOT  
Current ADT 360 VPD; Design Year ADT 468 VPD; % Trucks 10

b. Design Speed: 40 M.P.H

c. ROW: Existing N/A Ft.; Proposed N/A Ft.

b. ~~Proposed~~ Roadway Crown Width 30 Ft.  
Existing

e. Surface Type & Width:

Existing Asphalt 22 FT.  
Proposed Micro-Seal 22 FT.

### 8. Bridges:

a. Str. No. SA4700000000039 Suff Rtg. 99.9 Capacity 40 tons  
Remain in Place: Yes Existing Width 28 Ft.  
a. Str. No. SA4700000000040 Suff Rtg. 99.9 Capacity 40 tons  
Remain in Place: Yes Existing Width 28 Ft.  
a. Str. No. SA4700000000041 Suff Rtg. 98.8 Capacity 40 tons  
Remain in Place: Yes Existing Width 28 Ft.

### Road Connections at each End of Project:

South End, Surf.Type Asphalt Surf.Width 22' Rdwy.Width 30'  
North End, Surf.Type Asphalt Surf.Width 22' Rdwy.Width 30'

