

**ORDER: OPEN PUBLIC HEARING TO DETERMINE WHETHER OR NOT TO
APPROVE A CONDITIONAL USE PERMIT TO DEVELOP A
COMMERCIAL HIGH DENSITY (C-3) USE, A MINI-WAREHOUSE
FACILITY, IN A RURAL (A-1) DISTRICT ON LAFAYETTE
COUNTY PARCEL 189Z-32-009.01**

Motion was made by Larry Gillespie, duly seconded by David Rikard, to open Public Hearing to determine whether or not to approve a conditional use permit to develop a Commercial High Density (C-3) use, a min warehouse facility, in a Rural (A-1) District on Lafayette County Parcel 189Z-32-009.01.

The vote on the motion was as follows:

Supervisor Brent Larson, voted yes
Supervisor Larry Gillespie, voted yes
Supervisor David Rikard, voted yes
Supervisor Chad McLarty, voted yes
Supervisor Mike Roberts, voted yes

After the vote, President Roberts, declared the motion carried, this the 18th day of January, 2022.

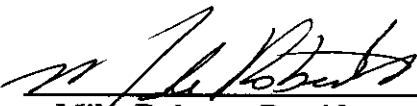

Mike Roberts, President
Board of Supervisors



Sherry Wall, Chancery Clerk

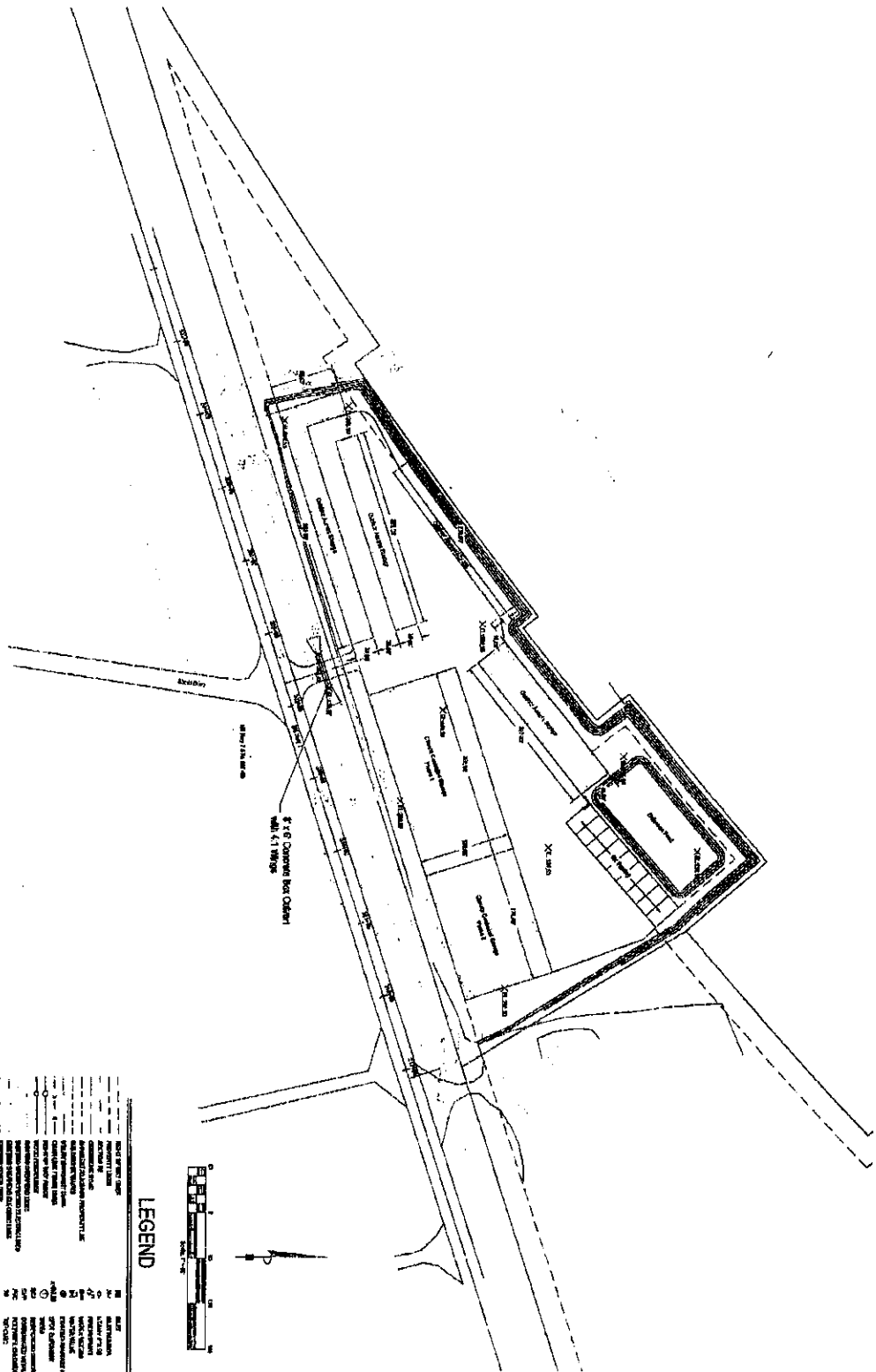

LEGEND

1. PROPOSED BUILDING FOOTPRINT	2. PROPOSED PARKING LOT	3. EXISTING DRIVEWAY	4. EXISTING DRIVEWAY
5. EXISTING DRIVEWAY	6. EXISTING DRIVEWAY	7. EXISTING DRIVEWAY	8. EXISTING DRIVEWAY
9. EXISTING DRIVEWAY	10. EXISTING DRIVEWAY	11. EXISTING DRIVEWAY	12. EXISTING DRIVEWAY
13. EXISTING DRIVEWAY	14. EXISTING DRIVEWAY	15. EXISTING DRIVEWAY	16. EXISTING DRIVEWAY
17. EXISTING DRIVEWAY	18. EXISTING DRIVEWAY	19. EXISTING DRIVEWAY	20. EXISTING DRIVEWAY
21. EXISTING DRIVEWAY	22. EXISTING DRIVEWAY	23. EXISTING DRIVEWAY	24. EXISTING DRIVEWAY
25. EXISTING DRIVEWAY	26. EXISTING DRIVEWAY	27. EXISTING DRIVEWAY	28. EXISTING DRIVEWAY
29. EXISTING DRIVEWAY	30. EXISTING DRIVEWAY	31. EXISTING DRIVEWAY	32. EXISTING DRIVEWAY
33. EXISTING DRIVEWAY	34. EXISTING DRIVEWAY	35. EXISTING DRIVEWAY	36. EXISTING DRIVEWAY
37. EXISTING DRIVEWAY	38. EXISTING DRIVEWAY	39. EXISTING DRIVEWAY	40. EXISTING DRIVEWAY
41. EXISTING DRIVEWAY	42. EXISTING DRIVEWAY	43. EXISTING DRIVEWAY	44. EXISTING DRIVEWAY
45. EXISTING DRIVEWAY	46. EXISTING DRIVEWAY	47. EXISTING DRIVEWAY	48. EXISTING DRIVEWAY
49. EXISTING DRIVEWAY	50. EXISTING DRIVEWAY	51. EXISTING DRIVEWAY	52. EXISTING DRIVEWAY
53. EXISTING DRIVEWAY	54. EXISTING DRIVEWAY	55. EXISTING DRIVEWAY	56. EXISTING DRIVEWAY
57. EXISTING DRIVEWAY	58. EXISTING DRIVEWAY	59. EXISTING DRIVEWAY	60. EXISTING DRIVEWAY
61. EXISTING DRIVEWAY	62. EXISTING DRIVEWAY	63. EXISTING DRIVEWAY	64. EXISTING DRIVEWAY
65. EXISTING DRIVEWAY	66. EXISTING DRIVEWAY	67. EXISTING DRIVEWAY	68. EXISTING DRIVEWAY
69. EXISTING DRIVEWAY	70. EXISTING DRIVEWAY	71. EXISTING DRIVEWAY	72. EXISTING DRIVEWAY
73. EXISTING DRIVEWAY	74. EXISTING DRIVEWAY	75. EXISTING DRIVEWAY	76. EXISTING DRIVEWAY
77. EXISTING DRIVEWAY	78. EXISTING DRIVEWAY	79. EXISTING DRIVEWAY	80. EXISTING DRIVEWAY
81. EXISTING DRIVEWAY	82. EXISTING DRIVEWAY	83. EXISTING DRIVEWAY	84. EXISTING DRIVEWAY
85. EXISTING DRIVEWAY	86. EXISTING DRIVEWAY	87. EXISTING DRIVEWAY	88. EXISTING DRIVEWAY
89. EXISTING DRIVEWAY	90. EXISTING DRIVEWAY	91. EXISTING DRIVEWAY	92. EXISTING DRIVEWAY
93. EXISTING DRIVEWAY	94. EXISTING DRIVEWAY	95. EXISTING DRIVEWAY	96. EXISTING DRIVEWAY
97. EXISTING DRIVEWAY	98. EXISTING DRIVEWAY	99. EXISTING DRIVEWAY	100. EXISTING DRIVEWAY



SOUTH ELEVATION (EXISTING HWY 7 SIDE)



NORTH ELEVATION (RELOCATED HWY 7 SIDE)