

ORDER: APPROVE PROGRAM FOR STATE AID PROJECT NO. LSBP-36(37)

Motion was made by Larry Gillespie, duly seconded by Brent Larson, to approve program for State Aid Project #LSBP-36(37).

The vote on the motion was as follows:

Supervisor Brent Larson, voted yes
Supervisor Larry Gillespie, voted yes
Supervisor David Rikard, voted yes
Supervisor Chad McLarty, voted yes
Supervisor Mike Roberts, voted yes

After the vote, President Roberts, declared the motion carried, this the 15th day of November, 2021.



**Mike Roberts, President
Board of Supervisors**



Sherry Wall, Chancery Clerk

Office of State Aid Road Construction

Mississippi Department of Transportation

Program Form LSBP



Project Number LSBP-36(37)

County IAFAYETTE

Date 11-15-2021

ORDER OF BOARD OF SUPERVISORS Lafayette COUNTY
SETTING FORTH PROPOSED LOCAL SYSTEM BRIDGE
REPLACEMENT AND REHABILITATION PROJECTS FOR PERIOD
January 1, 2020 THROUGH December 31, 2023

Pursuant to the provisions of House Bill 1302 of the 1994 Legislative Session and as subsequently amended, herein after referred to as said Act, We, the undersigned members of the Board of Supervisors of Lafayette County, hereby order that the proposed project(s) listed herein constitute the LSBP Program for Lafayette County for the period January 1, 2020 through December 31, 2023

In support of this order, the Board certifies and agrees that:

1. The Board has employed a Registered Professional Engineer and such other technical experts as may be necessary to perform all engineering services required, to properly supervise and inspect the work in compliance with the Rules and Regulations of the State Aid Engineer established in accordance with said Act.
2. The program, which has been prepared by the LSBP Engineer and approved by this Board, is herewith submitted to the State Aid Engineer for approval. The projects in said program are on the Off-System. (Non-State Aid, Non-Federal Aid)
3. The State Aid Engineer is authorized to effect such transfer of LSBP funds as are necessary to pay engineering costs on the projects as authorized by said Act and in accordance with the current Rules and Regulations promulgated by the State Aid Engineer.
4. The State Aid Engineer is authorized to effect such transfer of LSBP funds as are necessary to pay testing expenses incurred prior to the award of contract on any project(s) included in this program. In the event the Board cancels or withdraws any project(s) included in this Program, the Board hereby agrees to reimburse its Local system Bridge Replacement funds for any charges incurred and paid from LSBP funds.
5. The State Aid Engineer is authorized to ensure an equitable distribution of projects and funds among the County and incorporated Municipalities located therein based upon the proportional number and costs of deficient bridges in both the County and the Municipalities.
6. The Board will provide, at its own expense, adequate base and any necessary paving upon completion of the structure, in accordance with said Act and plans and specifications.
7. The Board will furnish an Agreement from the Municipality when a project is included in this program that is within a municipality.
8. The Board will maintain the projects located within their jurisdiction in a regular and satisfactory manner subject to the approval of the State Aid Engineer, all as required in said Act.
9. The Board will comply with all applicable Laws, Rules and Regulations in the acquisition of rights-of-way and will maintain the acquired rights-of-way for said project(s) to keep the same free of encroachments such as buildings, fences or any other obstructions. The Board designates Joe Bynum as its right-of-way acquisition agent for the project(s) herein. The agent's address and phone number is 142 Highway 7 South, Oxford, MS 38655 Phone: (662)234-4155
10. The Board herein affirms its acceptance of the Office of State Aid Road Construction's policy for the accommodation of utilities as stated in S.O.P. No. SA II-2-8 and agrees to coordinate utility facility installation and/or adjustment in a timely manner so as not to impede project development.



PROJECT PRIORITY NO. _____

1. Project No. **LSBP-36(37)**
2. Name of Road: **CR 210**
3. Design Classification: (check one) Rural Urban (check one) Collector Local
Federal Route Number **N/A**
4. Termini of Project: **Beginning at a point on the centerline of CR 210 100 ft. west of Lee Creek and go east for 200 ft. to a point on the centerline of said CR 210 located in Section 18, Township 7 South, Range 2, West.**
5. Length of Project: **0.038** Miles
6. Character of Work (Show Alternates if Applicable) **Box Bridge and Approaches**

7. Design Data:
 - a. Traffic Count: How Determined **Estimated**
Current ADT **50** VPD; Design Year ADT **39** VPD; %Trucks **10**
Traffic Count Required: Yes No (Attach Supplemental Sheet)
 - b. Terrain Level Rolling Design Speed **30** MPH
 - c. ROW: Existing _____ Ft.; Proposed **80** Ft.
 - d. Proposed Roadway Crown Width **26** Ft.
 - e. Surface Type & Width: Existing **DBST** **20** Ft.
Proposed **Temp. Gravel** **20** Ft.

8. Bridges:
 - a. Str. No. **SA3600000000024** Suff. Rtg. **53.9** Capacity **12T/9T**
Remain in Place: Yes No Existing/Proposed Width _____ Ft.
 - b. Str. No. _____ Suff. Rtg. _____ Capacity _____
Remain in Place: Yes No Existing/Proposed Width _____ Ft.
 - c. Str. No. _____ Suff. Rtg. _____ Capacity _____
Remain in Place: Yes No Existing/Proposed Width _____ Ft.
 - d. Str. No. _____ Suff. Rtg. _____ Capacity _____
Remain in Place: Yes No Existing/Proposed Width _____ Ft.
 - e. Str. No. _____ Suff. Rtg. _____ Capacity _____
Remain in Place: Yes No Existing/Proposed Width _____ Ft.

9. Estimated Construction Cost of Project (Including Contingencies) \$ **917,595**
 - a. STP Funds Requested (_____ %) \$ _____
 - b. BR Funds Requested (_____ %) \$ _____
 - c. SA Funds Requested (_____ %) \$ _____
 - d. LSBP Funds (**100** %) \$ **917,595**
 - e. _____ Funds \$ _____

- Engineering Cost (**12** %) (Constr. Cost Less Contingencies) \$ **104,868**
- a. State Aid Funds Requested \$ _____
 - b. County Funds Contributed \$ _____
 - c. LSBP Funds Contributed \$ **104,868**
 - d. _____ Funds Contributed \$ _____
- Total Estimated Cost of Project \$ **1,022,463**

Construction will be by: Contract County Forces

Use Supplemental Sheet and/or maps if needed to provide complete data.

FOR STATE AID USE ONLY:

Preliminary Review	_____	Date
Recommend Approval	_____ Dist. Engr.	Date
Approved	_____ State Aid Engr.	Date
Letter To Bd.	_____ Dist. Engr.	Date
Funds Record	_____ Auditor	Date
Programmed	_____	Date



BOARD OF SUPERVISORS

LAFAYETTE County

Grant Brown, Supervisor, District I

Carly Hueston, Supervisor, District II

David Rickard, Supervisor, District III

Urad McClary, Supervisor, District IV

[Signature], Supervisor, District V

Prepared by: [Signature], County Engineer

STATE OF MISSISSIPPI
COUNTY OF LAFAYETTE

This is to certify that the foregoing is a true and correct copy of an order passed by the Board of Supervisors of Lafayette County, Mississippi, entered into the minutes of the said Board of Supervisors, Electronic Minutes dated Nov. 15, 2021, same having been adopted at a meeting of said Board of Supervisors on the 15th day of November, 2021.

[Signature]
Clerk of Board of Supervisors of
Lafayette County, Mississippi

**OFFICE OF STATE AID ROAD CONSTRUCTION
MISSISSIPPI DEPARTMENT OF TRANSPORTATION
JACKSON, MISSISSIPPI**



DATA TO BE SUBMITTED WITH ALL PROJECT PROGRAMS

Project Number LSBP-36(37) County Lafayette Date _____

Road Connections at each End of Project
 (South or West) West End, Surf. Type DBST Surf. Width 20 Rdwy. Width 22
 (North or East) East End, Surf. Type DBST Surf. Width 20 Rdwy. Width 22

Railroad Grade Crossing Data
 Is there an existing Railroad Grade Crossing? Yes No

Name of Railroad N/A

Existing Protection N/A

Proposed Protection N/A

Existing and/or Proposed Facilities Effecting Route:

SCHOOLS: YES NO ON ROUTE OFF ROUTE
 INDUSTRY: YES NO ON ROUTE OFF ROUTE

TYPE OF INDUSTRY: None

OTHER DESIGN CONSIDERATIONS: None

UTILITY COMPANIES TO BE AFFECTED BY PROJECT:

NAME	STREET OR P.O. BOX ADDRESS	CITY
AT&T		Oxford

Signed
 County Engineer

PROJECT SITE
LSBP-36(37)

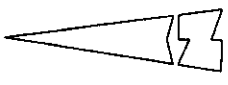
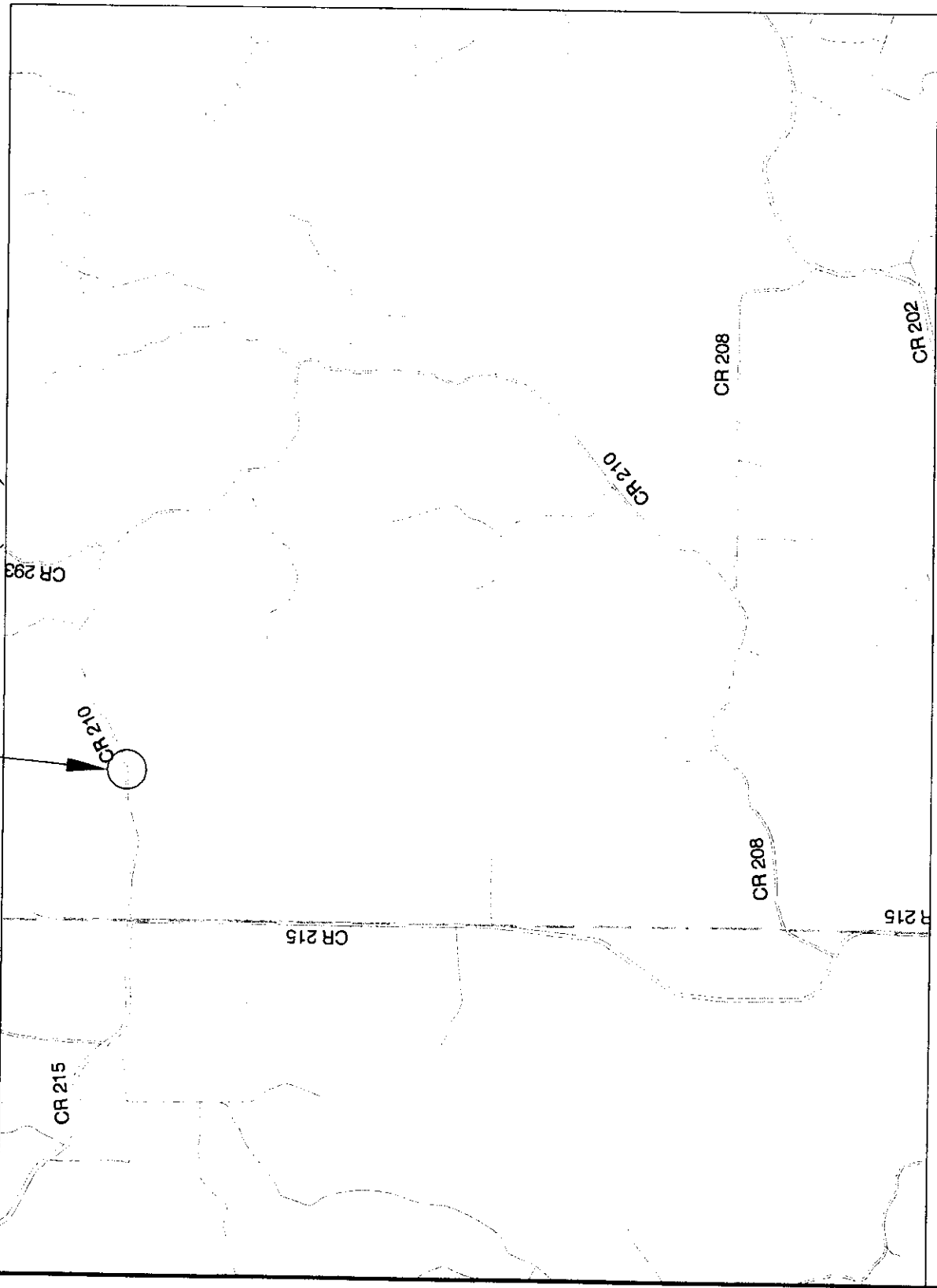

SCALE: 1"=3000'

LSBP-36(37)
LAFAYETTE COUNTY