

SECTION 25

TOWNSHIP 1

RANGE 3, E.

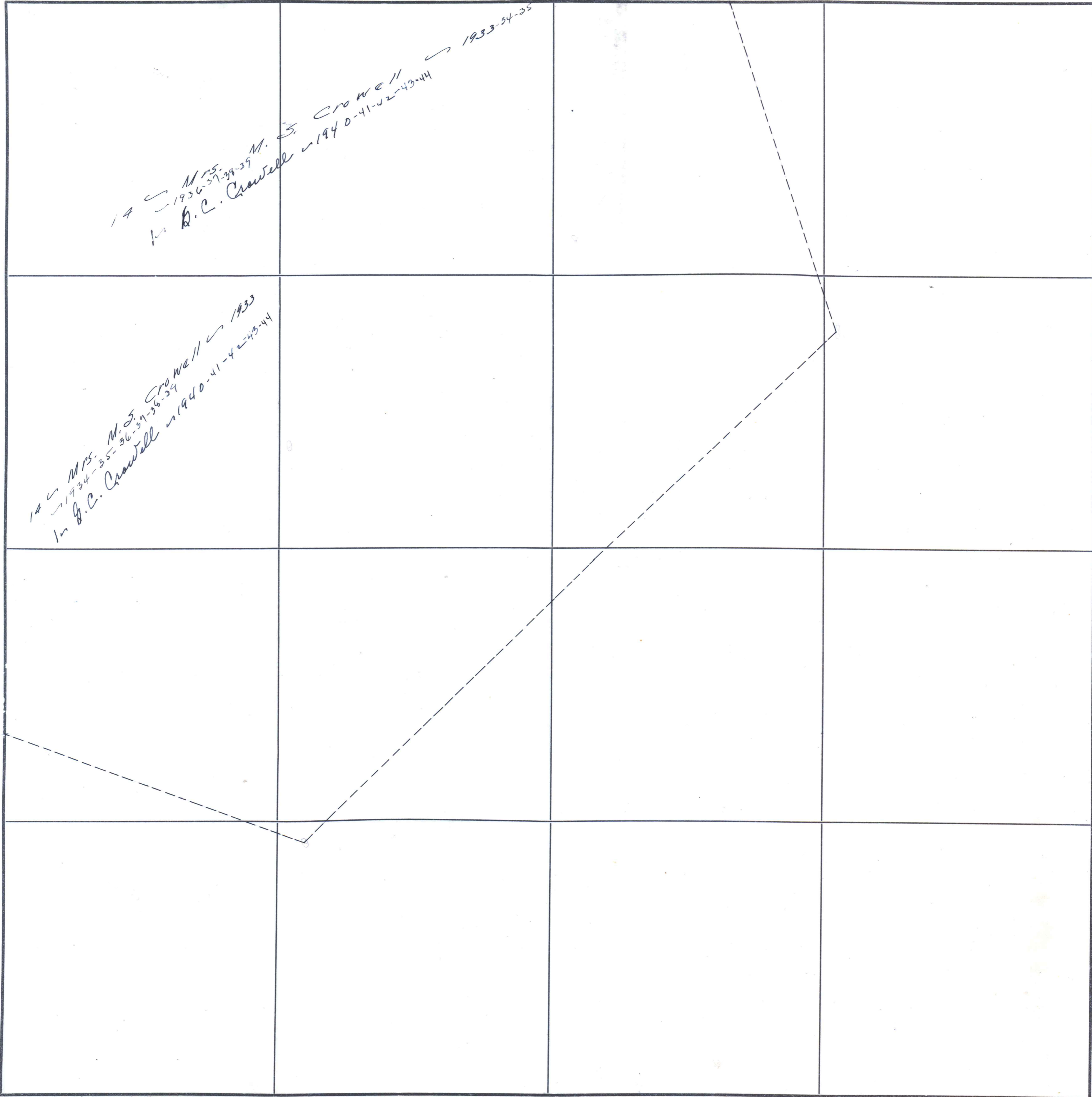

14 → Mrs. M.S. Crowell → 1933-34-35  
 → 1936-37-38-39 M.S. Crowell →  
 In G.C. Crowell → 1940-41-42-43-44

14 → Mrs. M.S. Crowell → 1933  
 → 1934-35-36-37-38-39 M.S. Crowell →  
 In G.C. Crowell → 1940-41-42-43-44

COUNTY \_\_\_\_\_