

Section **30**, Township **5** South, Range **3**, East.

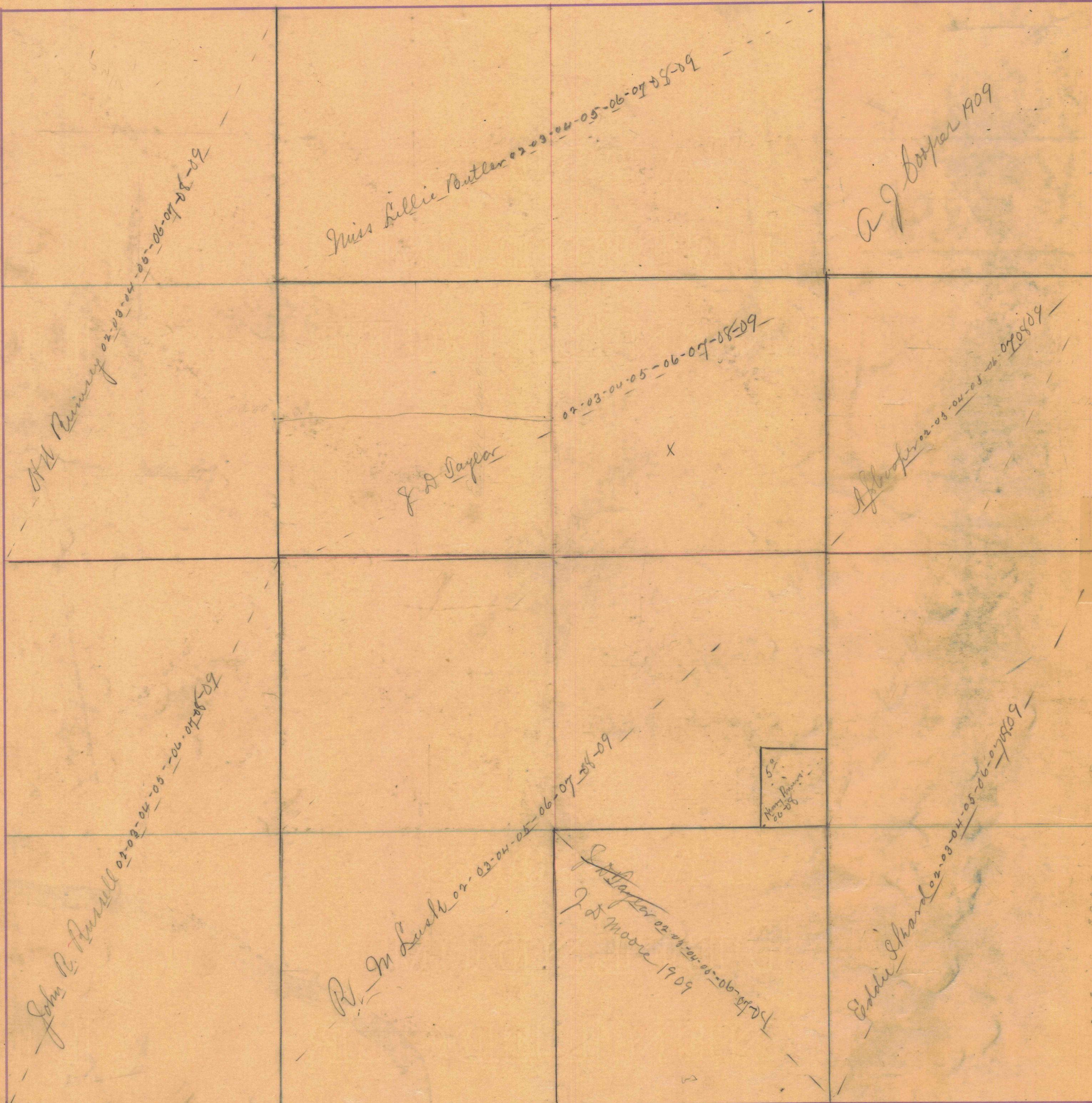

W. Quincy 02-03-04-05-06-07-08-09

Miss Lillie Butler 02-03-04-05-06-07-08-09

A. J. Cooper 1909

John A. Russell 02-03-04-05-06-07-08-09

R. M. Lusk 02-03-04-05-06-07-08-09

J. D. Taylor 02-03-04-05-06-07-08-09
J. D. Moore 1909

Eddie Shardon 02-03-04-05-06-07-08-09

50
W. Quincy
02-03-04-05-06-07-08-09