

SECTION 1

TOWNSHIP 1

RANGE 2 W

FORM 1—S.T.C.—ROBERTS & SON, BIRMINGHAM

STATE LINE ROAD

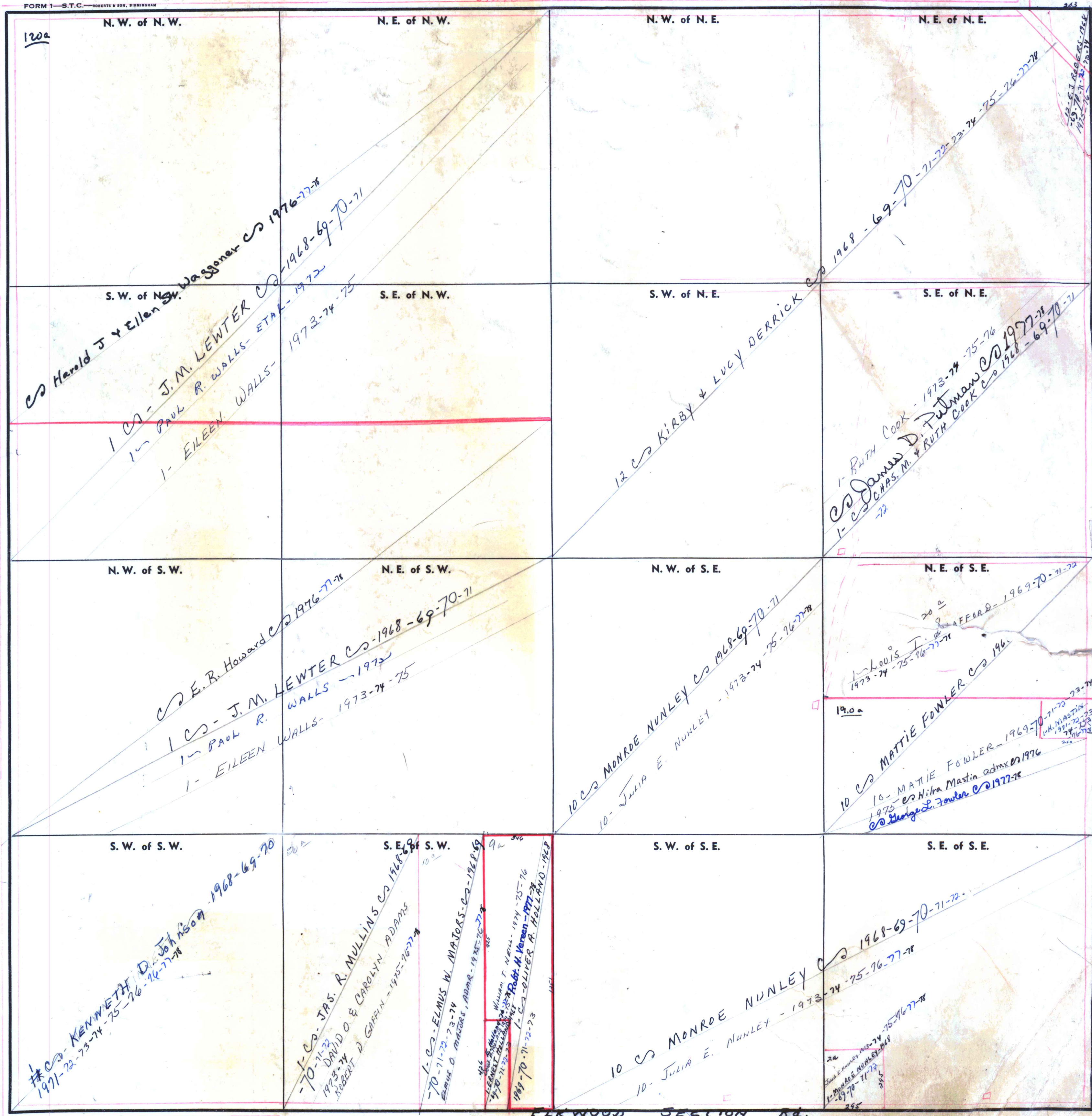

CHATEL GLOVE ROAD

6-1-1W EAST OF THIS SECTION

SCOTT ROAD

Scale—1 inch—300 Ft.

COUNTY _____

ELKWOOD SECTION RD.

1971-72-73-74-75-76-77-78
 1 CS - KENNETH D. JOHNSON 1968-69-70

1 CS - JAS. R. MULLINS CS 1968-69-70
 1973-74 DAVID O. & CAROLYN ADAMS
 ROBERT D. GAFFIN - 1975-76-77-78
 1 CS - ELMUS W. MAJORS - CS - 1968-69-70
 1970-71-72-73-74
 ELMO D. MAJORS, ADMR. - 1975-76-77-78
 1979-70-71-72-73
 WILSON T. NEILL - 1974-75-76
 ROBT. H. VEREEN - 1977-78
 1 CS - OLIVER R. HOLLAND - 1968-69-70

10 CS MONROE NUNLEY CS 1968-69-70-71
 10 - JULIA E. NUNLEY - 1973-74-75-76-77-78

10 CS MATTIE FOWLER CS 1968-69-70-71-72-73-74
 1975 CS Nitra Mastin admr CS 1976
 CS George L. Fowler CS 1977-78

CS Harold J & Ellen W. Waggoner CS 1976-77-78
 1 CS - J. M. LEWTER CS 1968-69-70-71
 1 - PAUL R. WALLS - ETAL - 1972
 1973-74-75
 1 - EILEEN WALLS

CS E. R. Howard CS 1976-77-78
 1 CS - J. M. LEWTER CS 1968-69-70-71
 1 - PAUL R. WALLS - 1972
 1973-74-75
 1 - EILEEN WALLS

10 CS MONROE NUNLEY CS 1968-69-70-71
 10 - JULIA E. NUNLEY - 1973-74-75-76-77-78

10 CS MATTIE FOWLER CS 1968-69-70-71-72-73-74
 1975 CS Nitra Mastin admr CS 1976
 CS George L. Fowler CS 1977-78

1 - RUTH COOK - 1973-74-75-76
 CS James D. Putman CS 1977-78
 1 - CS CHAS. M. & RUTH COOK CS 1968-69-70-71

12 CS Kirby & Lucy DERRICK CS 1968-69-70-71-72-73-74-75-76-77-78

1971-72-73-74-75-76-77-78
 1979-80-81-82-83-84-85-86-87-88-89-90-91-92-93-94-95-96-97-98-99-00