

Form 1-S.T.C. 5057 MARSHALL & BROWN CO. MINNESOTA

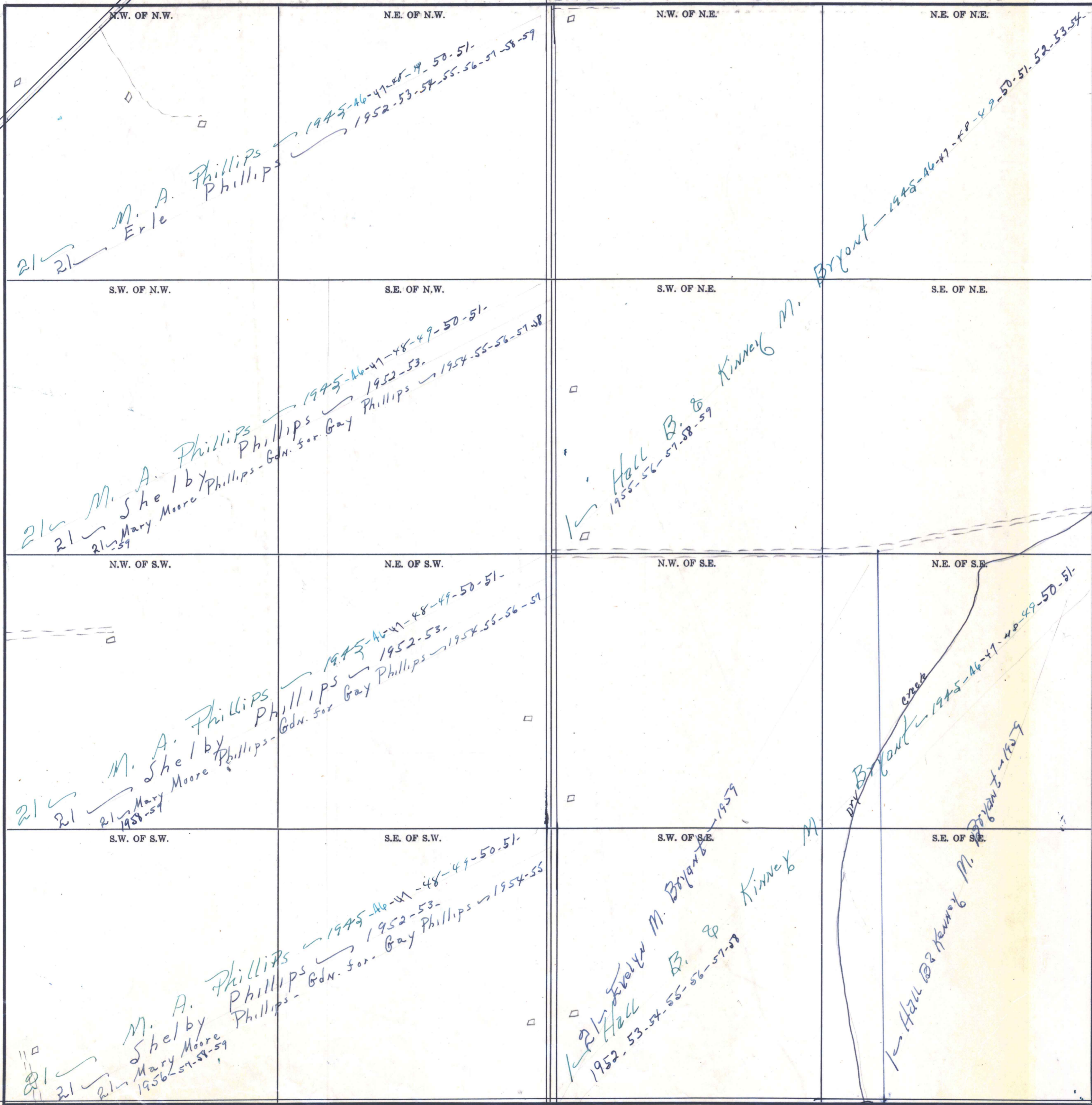

N.W. OF N.W.

N.E. OF N.W.

N.W. OF N.E.

N.E. OF N.E.

S.W. OF N.W.

S.E. OF N.W.

S.W. OF N.E.

S.E. OF N.E.

N.W. OF S.W.

N.E. OF S.W.

N.W. OF S.E.

N.E. OF S.E.

S.W. OF S.W.

S.E. OF S.W.

S.W. OF S.E.

S.E. OF S.E.

M. A. Erle
Phillips
Phillips

1945-46-47-48-49-50-51-
1952-53-54-55-56-57-58-59

Bryant - 1945-46-47-48-49-50-51-52-53-54

21 M. A. Phillips
21 Shelby Phillips
21 Mary Moore Phillips - Gdn. son. Gay Phillips
1945-46-47-48-49-50-51-
1952-53-
1954-55-56-57-58

Hall B. & Kinney M.
1955-56-57-58-59

21 M. A. Phillips
21 Shelby Phillips
21 Mary Moore Phillips - Gdn. son. Gay Phillips
1945-46-47-48-49-50-51-
1952-53-
1954-55-56-57

Creek
Bryant - 1945-46-47-48-49-50-51-
Bryant - 1959

21 M. A. Phillips
21 Shelby Phillips
21 Mary Moore Phillips - Gdn. son. Gay Phillips
1945-46-47-48-49-50-51-
1952-53-
1954-55

Hall B. & Kinney M.
1952-53-54-55-56-57-58

Hall B. & Kinney M.
Bryant - 1959