

SECTION

29

TOWNSHIP

6

RANGE

2E

FORM 1—S.T.C.—ROBERTS & SON, BIRMINGHAM

N.W. of N.W.

N.E. of N.W.

N.W. of N.E.

N.E. of N.E.

S.W. of N.W.

S.E. of N.W.

S.W. of N.E.

S.E. of N.E.

N.W. of S.W.

N.E. of S.W.

N.W. of S.E.

N.E. of S.E.

S.W. of S.W.

S.E. of S.W.

S.W. of S.E.

S.E. of S.E.

CARRIED IN  
6-2E-30  
\* 2

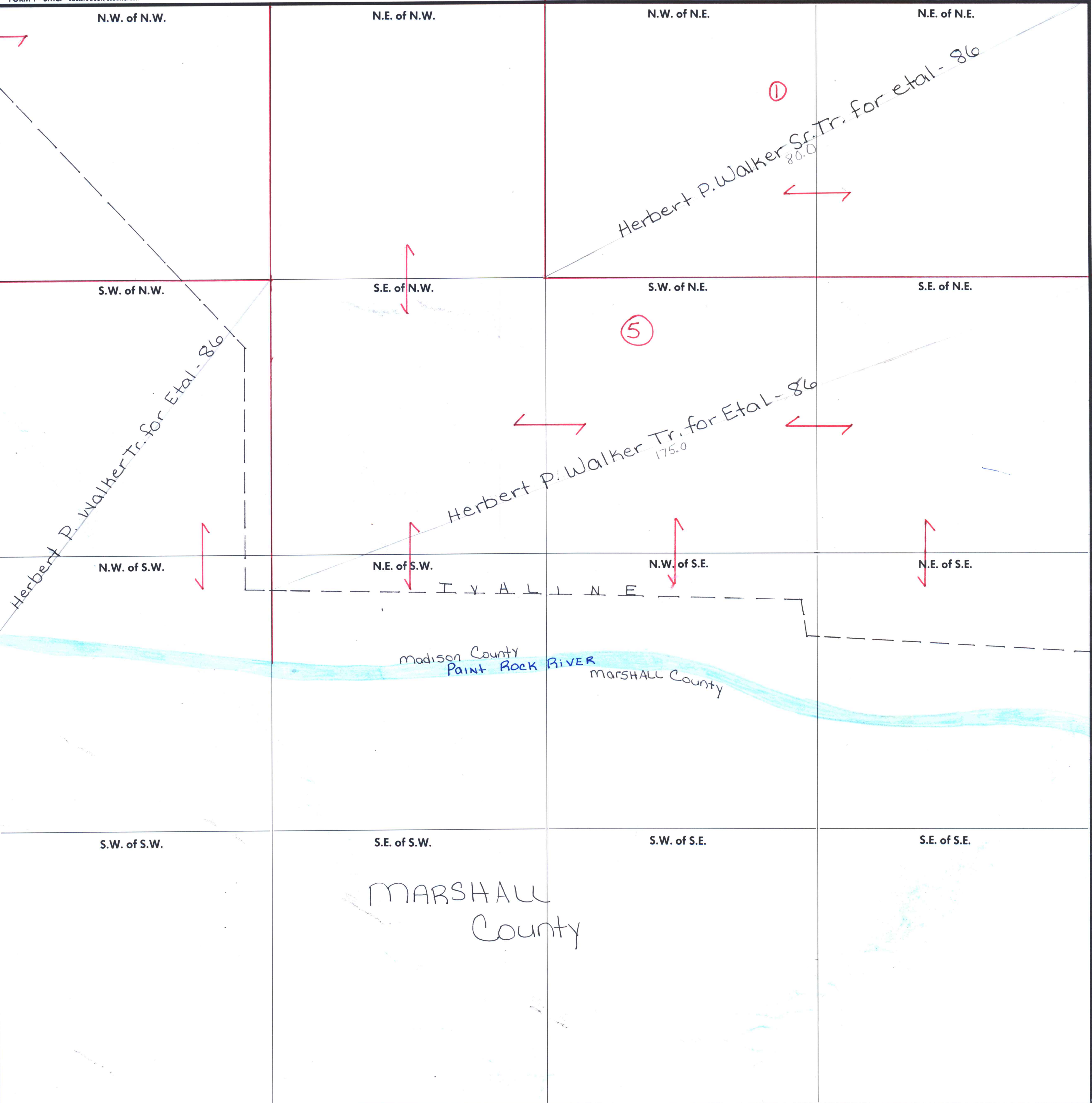

Herbert P. Walker Tr. for Etal - 86

Herbert P. Walker Sr. Tr. for etal - 86  
80.0

Herbert P. Walker Tr. for Etal - 86  
175.0

madison County  
Paint Rock RIVER  
MARSHALL County

MARSHALL  
County