

Section **33**, Township **2** South, Range **2**, East.

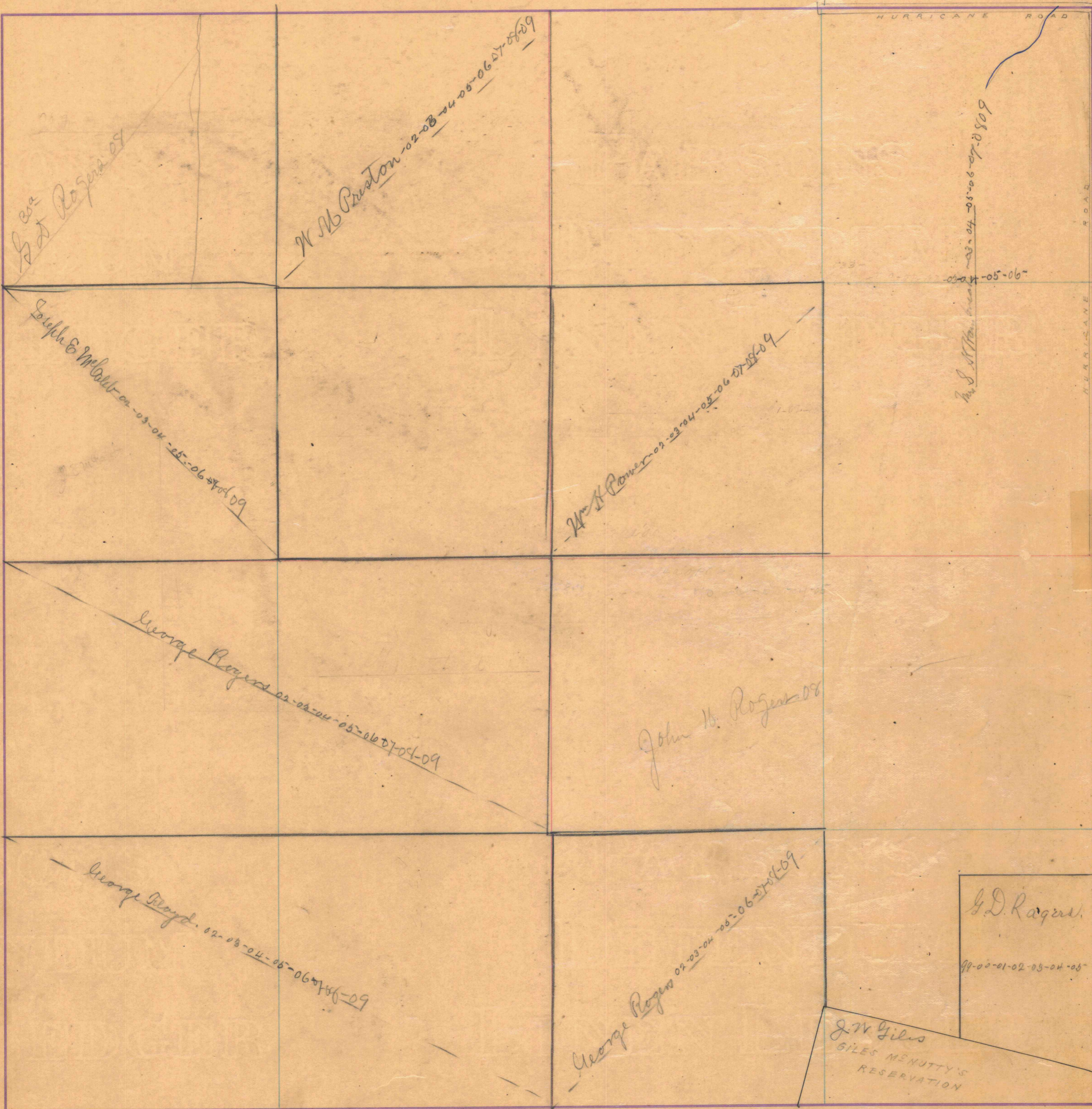

S. W. Rogers 09

W. M. Preston 02-03-04-05-06-07-08-09

HURRICANE ROAD
Mrs. J. W. Rogers 02-03-04-05-06-07-08-09

Joseph E. McCall 02-03-04-05-06-07-08-09

W. H. Power 02-03-04-05-06-07-08-09

George Rogers 02-03-04-05-06-07-08-09

John W. Rogers 08

George Rogers 02-03-04-05-06-07-08-09

George Rogers 02-03-04-05-06-07-08-09

G. D. Rogers
02-03-04-05-06-07-08-09

J. W. Giles
GILES MENUTTY'S
RESERVATION