

Section **10**, Township **2** South, Range **2**, East.

Frank Weyford 1909

W. F. Weyford '97-98-99-00-01-02-03-04-05-06

Joseph Rodgers -03-04-09

Mrs R. C. Brummett 20⁰⁰ 06-07

D. W. S. L. Mitchell 20⁰⁰ 05-

Mrs Fannie Woodall 03-

John W. Manning 1909

W. F. Weyford '97-98-99-00-01-02-03-04-05-06-07-08-09

W. F. Weyford '97-98-99-00

W. F. Weyford '97-98-99-00-01-02-03-04-05-06-07-08-09

Frank Weyford '97-98-99-00-01-02-03-04-05-06-07-08-09

Frank Weyford '97-98-99-00-01-02-03-04-05-06-07-08-09

Richard St Clair 91⁰⁰ 06-07-08-09

John C. Kennedy 09

W. F. Weyford '97-98-99-00-01-02-03-04-05-06-07-08-09

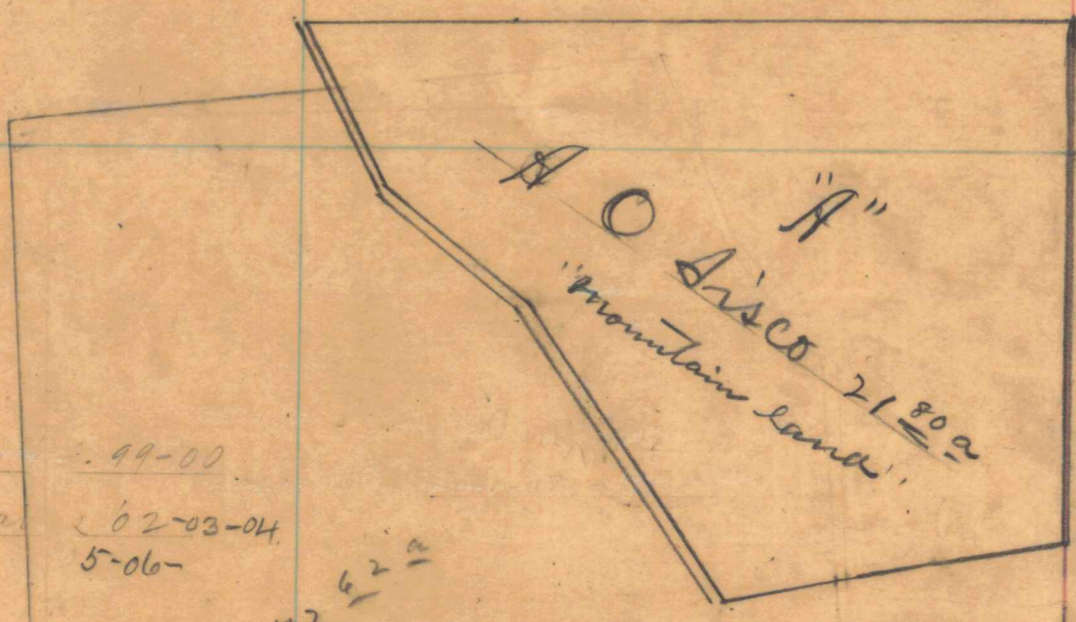

W. F. Weyford '97-98-99-00-01-02-03-04-05-06-07-08-09

W. F. Weyford '97-98-99-00-01-02-03-04-05-06-07-08-09

John C. Kennedy 09