

SECTION

15.4

TOWNSHIP

4

RANGE

1W

192

FORM 1-S.T.C. - ROBERTS & SON, BIRMINGHAM

SW  
OF  
NW

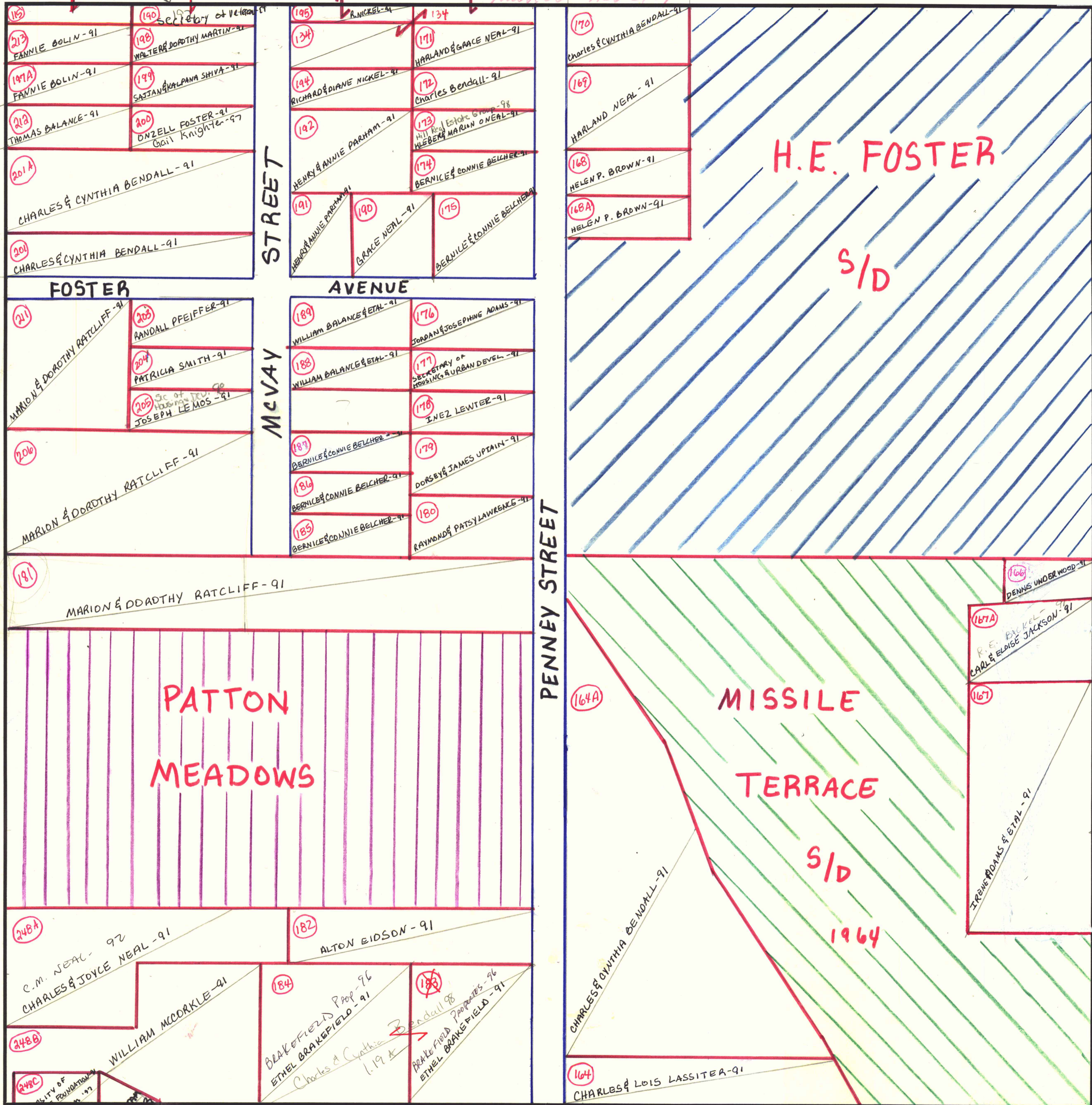

FOSTER AVENUE

STREET

McVay

PENNEY STREET

PATTON MEADOWS

MISSILE TERRACE

185  
190  
198  
199  
200  
201A  
201

Secretary of Veterans  
FANNIE BOLIN - 91  
WALTER DOROTHY MARTIN - 91  
SATTAN KALPANA SHIVA - 91  
ONZELL FOSTER - 91  
GAIL KNIGHT - 97  
CHARLES & CYNTHIA BENDALL - 91  
CHARLES & CYNTHIA BENDALL - 91

195  
134  
134  
144  
192  
191  
190  
175

NICKEL - 91  
HARLAND & GRACE NEAL - 91  
RICHARD & DIANE NICKEL - 91  
HENRY & ANNIE PARHAM - 91  
HENRY ANNIE PARHAM  
GRACE NEAL - 91  
BERNICE & CONNIE BELCHER  
BERNICE & CONNIE BELCHER

170  
169  
168  
168A

Charles & CYNTHIA BENDALL - 91  
HARLAND NEAL - 91  
HELEN P. BROWN - 91  
HELEN P. BROWN - 91

201  
203  
204  
205  
206

MARION & DOROTHY RATCLIFF - 91  
RANDALL PFEIFFER - 91  
PATRICIA SMITH - 91  
JOSEPH LE MOS - 91  
MARION & DOROTHY RATCLIFF - 91

189  
188  
187  
186  
185

WILLIAM BALANCE & ETAL - 91  
WILLIAM BALANCE & ETAL - 91  
BERNICE & CONNIE BELCHER  
BERNICE & CONNIE BELCHER  
BERNICE & CONNIE BELCHER

176  
177  
178  
179  
180

JORDAN & JOSEPHINE ADAMS - 91  
SECRETARY OF HOUSING & URBAN DEVEL - 91  
INEZ LEWIS - 91  
DORSEY & JAMES UPTAIN - 91  
RAYMOND & PATSY LAWRENCE - 91

191

MARION & DOROTHY RATCLIFF - 91

166  
167A  
167  
164A  
164

DENNIS UNDERWOOD - 91  
R.E. BELCHER - 91  
CARL & ELAISE JACKSON - 91  
IRENE ADAMS & ETAL - 91  
CHARLES & LOIS LASSITER - 91

248A  
248B  
248C  
248E  
248F  
248G  
248H  
248A  
248B

C.M. NEAL - 92  
CHARLES & JOYCE NEAL - 91  
WILLIAM MCCORKLE - 91  
BLAKEFIELD Prop - 96  
ETHEL BRAKEFIELD - 91  
Charles & Cynthia Bendall 98  
BLAKEFIELD Properties - 96  
ETHEL BRAKEFIELD - 91  
UNIVERSITY OF ALA BATTLE FOUNDATION  
JAMES SWEENEY - 91  
J. SANDOZ

COUNTY MADISON

Cont. from 4-N-15