

SECTION

25

TOWNSHIP

3

RANGE

1W

FORM 1—S.T.C.—ROBERTS & SON, BIRMINGHAM

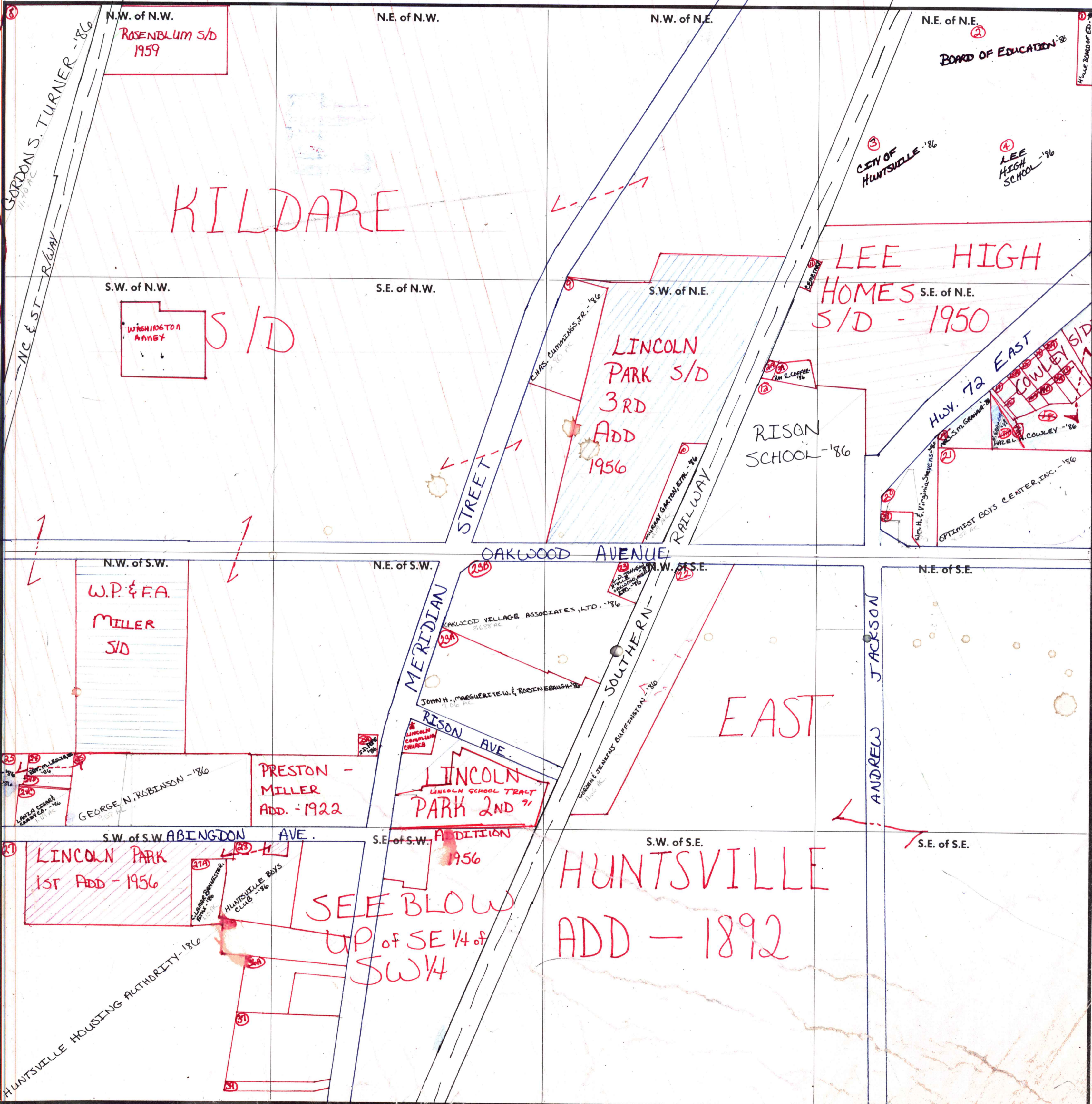

- 10A Linnie G. Tims - 186
- 11 H.V. Bible Church
- 12 ALVA GLEN SLAYTON - 186
- 13 ALVA G. SLAYTON - 186
- 14 ALVA G. SLAYTON - 186
- 15 JOHN W. WOODMAN - 186
- 16 MRS. JAMES O. CROWL - 186
- 17 JAMES JAMES CROWL - 186
- 18 JAMES E. HAYES, EXEC. - 186
- 19 JAMES E. HAYES, EXEC. - 186
- 20 JAMES E. HAYES, EXEC. - 186
- 21 JAMES E. HAYES, EXEC. - 186
- 22 JAMES E. HAYES, EXEC. - 186
- 23 JAMES E. HAYES, EXEC. - 186
- 24 JAMES E. HAYES, EXEC. - 186
- 25 JAMES E. HAYES, EXEC. - 186
- 26 JAMES E. HAYES, EXEC. - 186
- 27 JAMES E. HAYES, EXEC. - 186
- 28 JAMES E. HAYES, EXEC. - 186
- 29 JAMES E. HAYES, EXEC. - 186
- 30 JAMES E. HAYES, EXEC. - 186
- 31 JAMES E. HAYES, EXEC. - 186
- 32 JAMES E. HAYES, EXEC. - 186
- 33 JAMES E. HAYES, EXEC. - 186
- 34 JAMES E. HAYES, EXEC. - 186
- 35 JAMES E. HAYES, EXEC. - 186
- 36 JAMES E. HAYES, EXEC. - 186
- 37 JAMES E. HAYES, EXEC. - 186
- 38 JAMES E. HAYES, EXEC. - 186
- 39 JAMES E. HAYES, EXEC. - 186
- 40 JAMES E. HAYES, EXEC. - 186