

SECTION

6

TOWNSHIP

4

RANGE

1W

FORM 1—S.T.C.—ROBERTS & SON, BIRMINGHAM

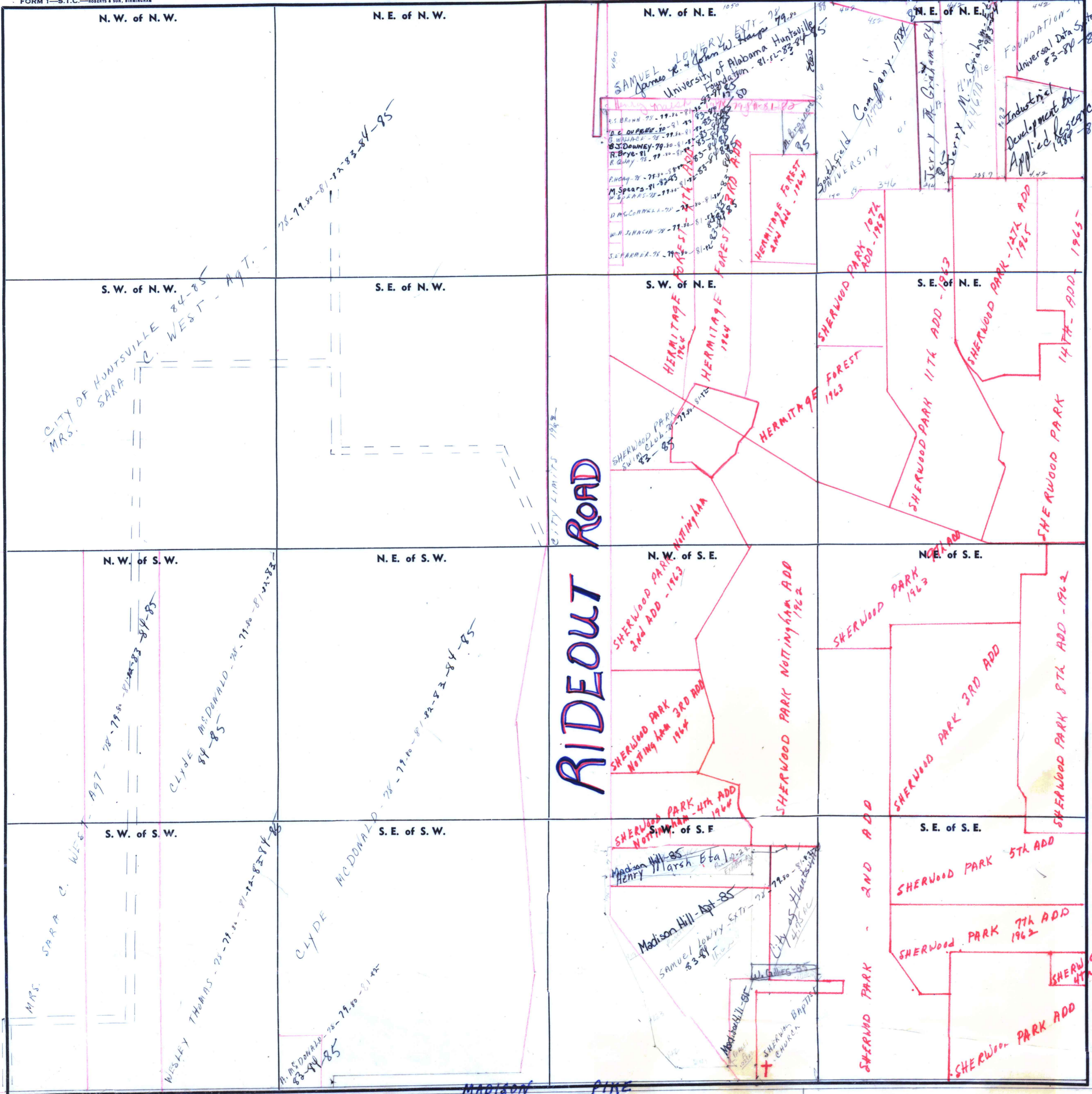

Scale—1 inch=300 Ft.

COUNTY

see 31

85

79-80-81-82-83

FOUNDATION - Universal Data Systems - 83-84-85

Industrial Development & Applied Research - 1984-85

Jerry M. Graham 4461A 1983

Sherwood Park 10th ADD - 1969

HERMITAGE FOREST 2ND ADD - 1964

SAMUEL LOWERY EXT - 78  
 James E. & John W. Hays  
 University of Alabama Huntsville Foundation - 81-82-83-84-85

SHERWOOD PARK SW 1/4 CLUB 83-85

HERMITAGE FOREST 1964

HERMITAGE FOREST 1964

HERMITAGE FOREST 1963

SHERWOOD PARK 11TH ADD - 1963

SHERWOOD PARK 12TH ADD - 1965

SHERWOOD PARK 14TH ADD - 1963

SHERWOOD PARK 14TH ADD - 1963

SHERWOOD PARK 1ST ADD - 1963

SHERWOOD PARK 2ND ADD - 1964

SHERWOOD PARK 3RD ADD - 1964

SHERWOOD PARK 4TH ADD - 1964

SHERWOOD PARK NOTTINGHAM ADD - 1962

SHERWOOD PARK 5TH ADD - 1962

SHERWOOD PARK 6TH ADD - 1962

SHERWOOD PARK 7TH ADD - 1962

SHERWOOD PARK 8TH ADD - 1962

SHERWOOD PARK 9TH ADD - 1961

SHERWOOD PARK ADD

Madison Hill - 85  
 Henry Marsh Etna  
 Samuel Lowery EXT - 78  
 83-84  
 W. Gilleg - 85  
 Madison Hill - 85  
 SHERWOOD BAPTIST CHURCH

CLYDE McDONALD - 78-79-80-81-82-83-84-85

WESLEY THOMAS - 78-79-80-81-82-83-84-85

CITY OF HUNTSVILLE  
 MRS. SARA C. WEST - A97

78-79-80-81-82-83-84-85

RIDEOUT ROAD

MADISON PINE