

SECTION 17

TOWNSHIP 3

RANGE 1E

FORM 1—S.T.C.—ROBERTS & SON, BIRMINGHAM

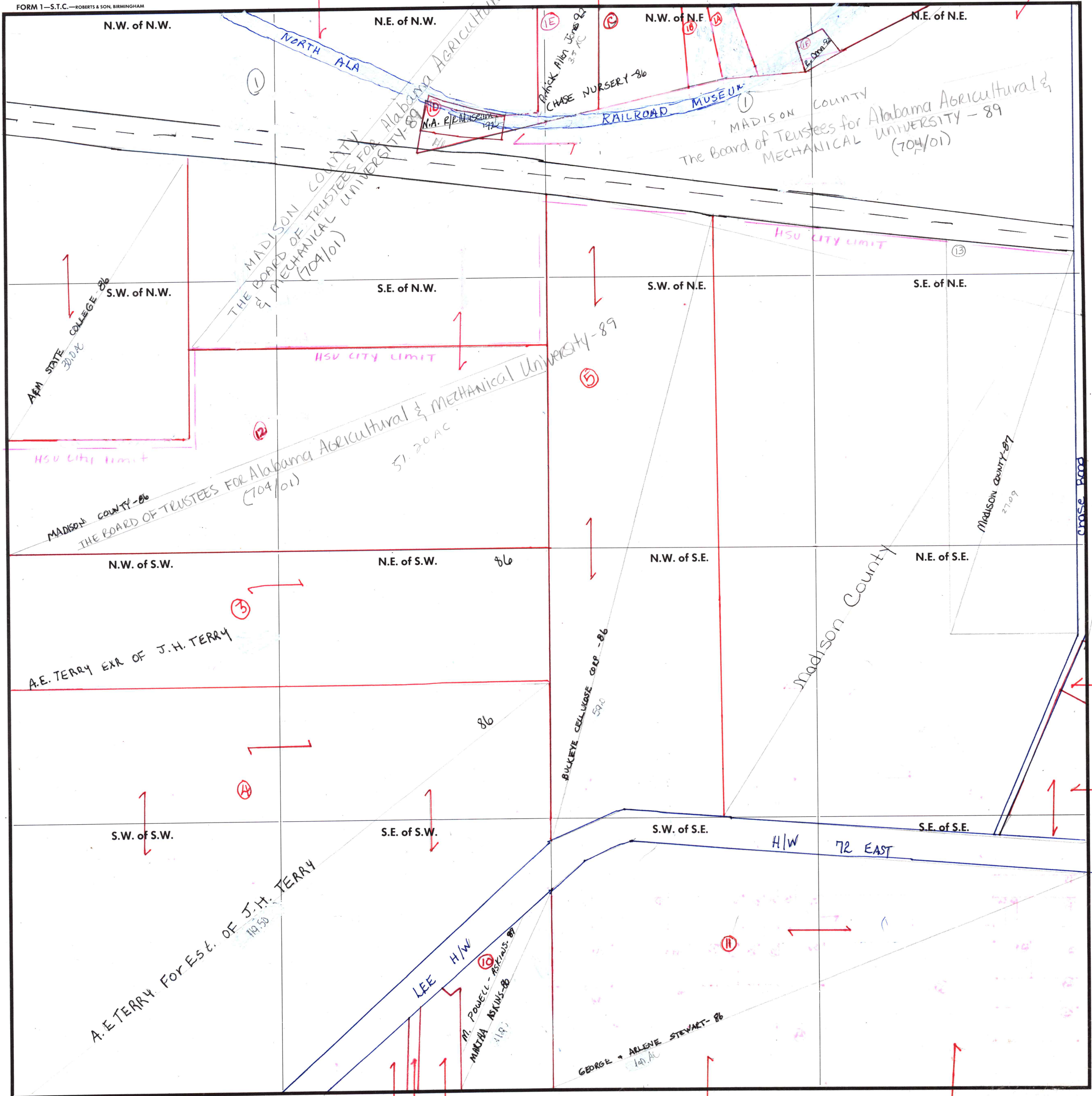

COUNTY MADISON

Scale - 1 inch = 300 Ft.

CARRIED IN
3-1E-20

AC. CARRIED
in 3-1E-20
part

CARRIED FROM
3-1E-16-#-11

CARRIED FROM
3-1E-16

Map of - City of HSV

MADISON COUNTY
THE BOARD OF TRUSTEES FOR
ALABAMA AGRICULTURAL
& MECHANICAL UNIVERSITY - 89
(704/01)

MADISON County
The Board of Trustees for Alabama Agricultural
& MECHANICAL UNIVERSITY - 89
(704/01)

Madison County

MADISON COUNTY - 87
2709

A&M STATE COLLEGE - 86
300 AC

MADISON COUNTY - 86
THE BOARD OF TRUSTEES FOR ALABAMA AGRICULTURAL
& MECHANICAL UNIVERSITY - 89
(704/01)

A.E. TERRY EXR OF J.H. TERRY

A.E. TERRY For Est. OF J.H. TERRY
119.50

LEE H/W
M. POWELL - RESID. - 87
MARSHA ASKINS - 88
4197

GEORGE & ARLENE STEWART - 86
140 AC

BUCKEYE CELLULOSE CORP - 86
590

CHASE ROAD