

SECTION 29

TOWNSHIP 5

RANGE 1E

FORM 1—S.T.C.—ROBERTS & SON, BIRMINGHAM

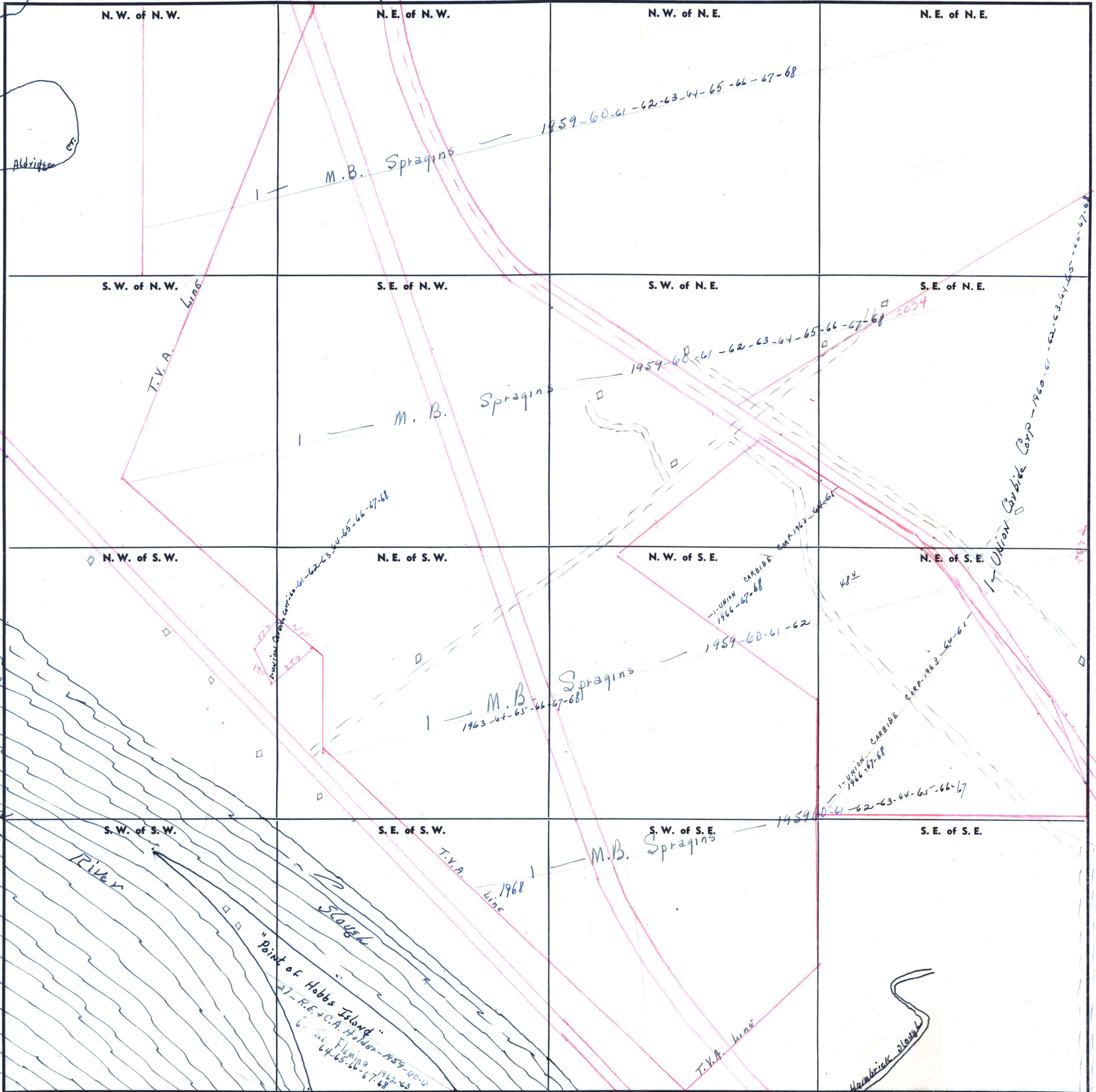

N.W. of S.W.

N.E. of S.W.

N.W. of S.E.

N.E. of S.E.

S.W. of S.W.

S.E. of S.W.

S.W. of S.E.

S.E. of S.E.

N.W. of N.W.

N.E. of N.W.

N.W. of N.E.

N.E. of N.E.

S.W. of N.W.

S.E. of N.W.

S.W. of N.E.

S.E. of N.E.

COUNTY

Scale—1 inch—300 Ft.

Aldridge

M.B. Spragins

1959-60-61-62-63-64-65-66-67-68

T.V.A. Line

M.B. Spragins

1959-60-61-62-63-64-65-66-67-68

1959-60-61-62-63-64-65-66-67-68

M.B. Spragins
1963-64-65-66-67-68

1959-60-61-62

484

1966-67-68

1959-60-61-62-63-64-65-66-67

River

Slough

"Point of Hobbs Island"

RE. & C.A. Holder-1959-60-61
FLEMING 1962-63
64-65-66-67-68

M.B. Spragins

1968

T.V.A. Line

Hambick Slough

Union Carbide Corp-1960-61-62-63-64-65-66-67-68