

Section **36**, Township **1** South, Range **1**, East.

M. J. ... \$1000
92-98-99-00-01-02-03-04-05-06
07-08

Osman
1913

Cornelia Sledge
27^a Parice
Feb Drake - 20^e
14^e Harriet Morris

60-65-66-67-68-69-70-71-72-73-74-75-76-77-78-79
Mrs Bibb Crutcher

871-
O. Stone '01-02-03-04-
05-
180

A L Miller & Ballie Taylor
00-01-02-03-04-05-06-07-08-09

Cornelia Sledge 9^a 04-09
Clara Sledge 1^a 09

John O. Cannon
1918
816
m-64^a 12 25 1/4

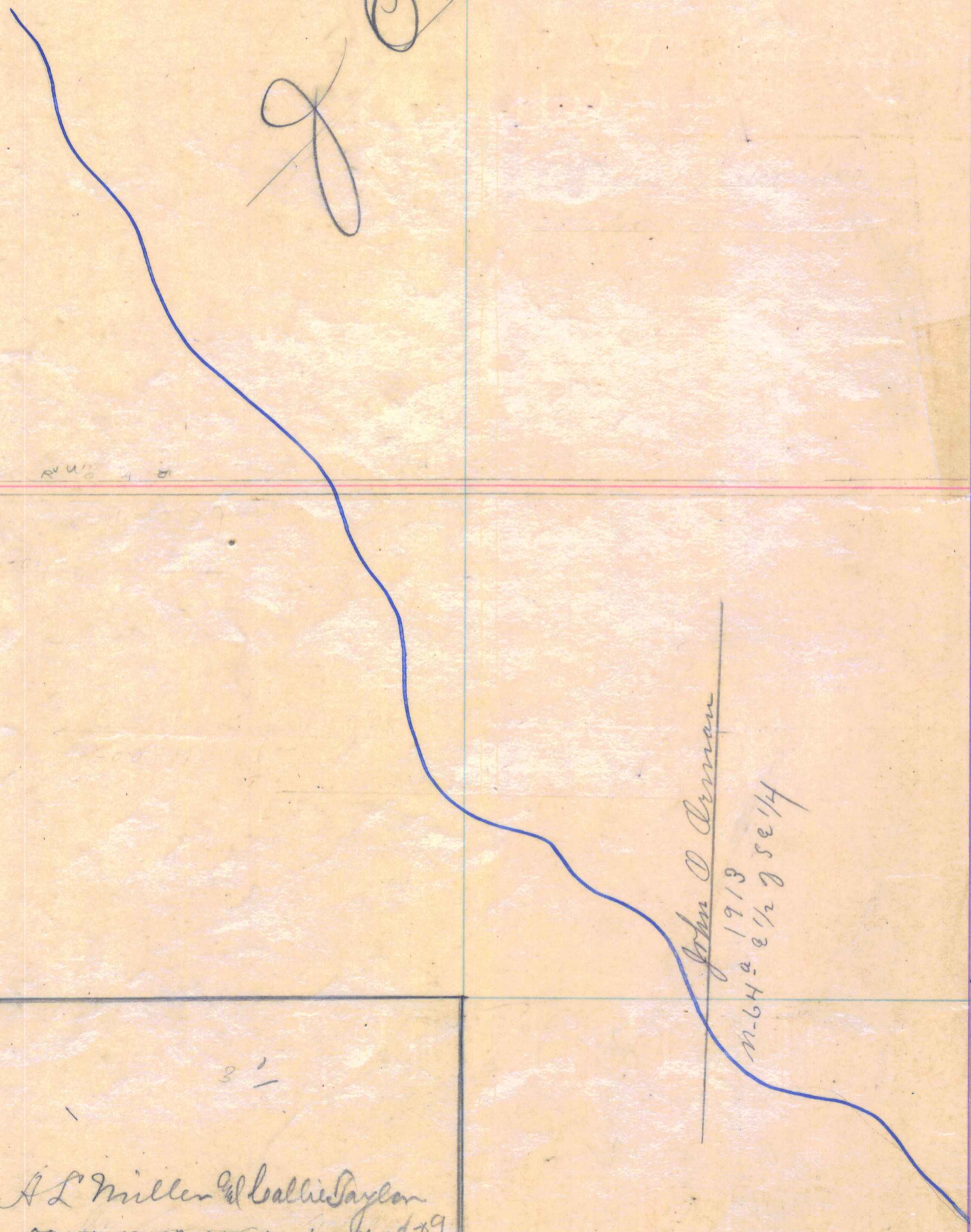

g

Small illegible stamp or mark in the bottom right corner.