

**ORDER: SPREAD ON THE MINUTES LOCAL GOVERNMENT REQUEST FOR  
TEMPORARY EMERGENCY DEBRIS MANAGEMENT SITE**

Motion was made by Greg Bynum, duly seconded by Tim Gordon, to spread on the minutes Local Government request for temporary Emergency Debris Management Site.

The vote on the motion was as follows:

Supervisor Brent Larson, voted yes  
Supervisor John Morgan, voted yes  
Supervisor Tim Gordon, voted yes  
Supervisor Scott Allen, voted yes  
Supervisor Greg Bynum, voted yes

After the vote, President Larson, declared the motion carried, this the 17<sup>th</sup> day of February, 2026.

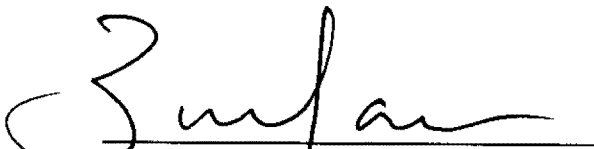
  
\_\_\_\_\_  
Brent Larson, President  
Board of Supervisors

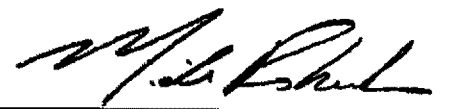
  
\_\_\_\_\_  
Mike Roberts, Chancery Clerk

## LOCAL GOVERNMENT REQUEST FOR A TEMPORARY EMERGENCY DEBRIS MANAGEMENT SITE

(A separate form should be completed for each emergency site requested.)

### CONTACT INFORMATION

Local Government: <u>Lafayette County, Mississippi</u> County: <u>Lafayette</u>	
Primary Local Government Contact Person: Name: <u>Kate Victor</u> Title: <u>County Administrator</u> Address 1: <u>300 North Lamar Blvd.</u> Address 2: _____ City: <u>Oxford</u> State: <u>MS</u> Zip: <u>38655</u> Phone: <u>(662) 236-2717</u> Fax: _____ Email: <u>kvictor@lafayettecoms.com</u>	Primary Site Operations Contact (if known): Name: <u>Sean Hunt</u> Title: <u>Vice President</u> Address 1: <u>1501 Hwy 13 N</u> Address 2: _____ City: <u>Columbia</u> State: <u>MS</u> Zip: <u>39429</u> Phone: <u>(901) 910-8560</u> Fax: _____ Email: <u>Seanhunt@looksgreatservices.com</u>

### SITE INFORMATION

Type of Temporary Emergency Debris Management Site (check all that apply):

Vegetative Debris (trees, limbs, leaves, etc.):  Staging  Chipping  Other: \_\_\_\_\_

Structural Debris (brick, lumber, siding, roofing, furniture, etc.):  Staging

Physical Address (or Location) of Site: 136 Co Rd 423 Oxford, MS 38655

Attach a high quality topographic map or aerial photograph (with property boundaries, if possible).

Attach a description of the site's ability to comply with MDEQ location restrictions.

GPS Location (if available): Latitude: N 34 ° 17 ' 52.0 " Longitude: W 89 ° 20 ' 24.3 "

Anticipated Period of Operation: February 5, 2026 to May 8, 2026

- Attach a copy of a local government resolution declaring the need for this emergency debris site, including debris type and quantity estimates and a discussion on the availability of existing solid waste disposal facilities in the area.
- Attach documentation demonstrating the local government has the consent of the property owner(s) to conduct the proposed emergency operations at the location.
- Attach a description of the final disposal or beneficial use plans for all debris, chipped wood, and other solid waste managed at the site.

### SIGNATURE OF RESPONSIBLE OFFICIAL

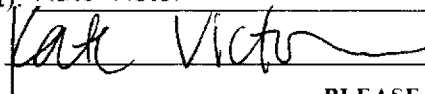
Name (print): <u>Kate Victor</u>	Title: <u>County Administrator</u>
Signature: 	Date: <u>2/5/2026</u>

**PLEASE SUBMIT TO TRENT JONES:**

Email: [tjones@mdeq.ms.gov](mailto:tjones@mdeq.ms.gov)

MDEQ – Waste Division: P. O. Box 2261, Jackson, MS 39225

Phone: (601) 961-5171 Fax: (601) 961-5785

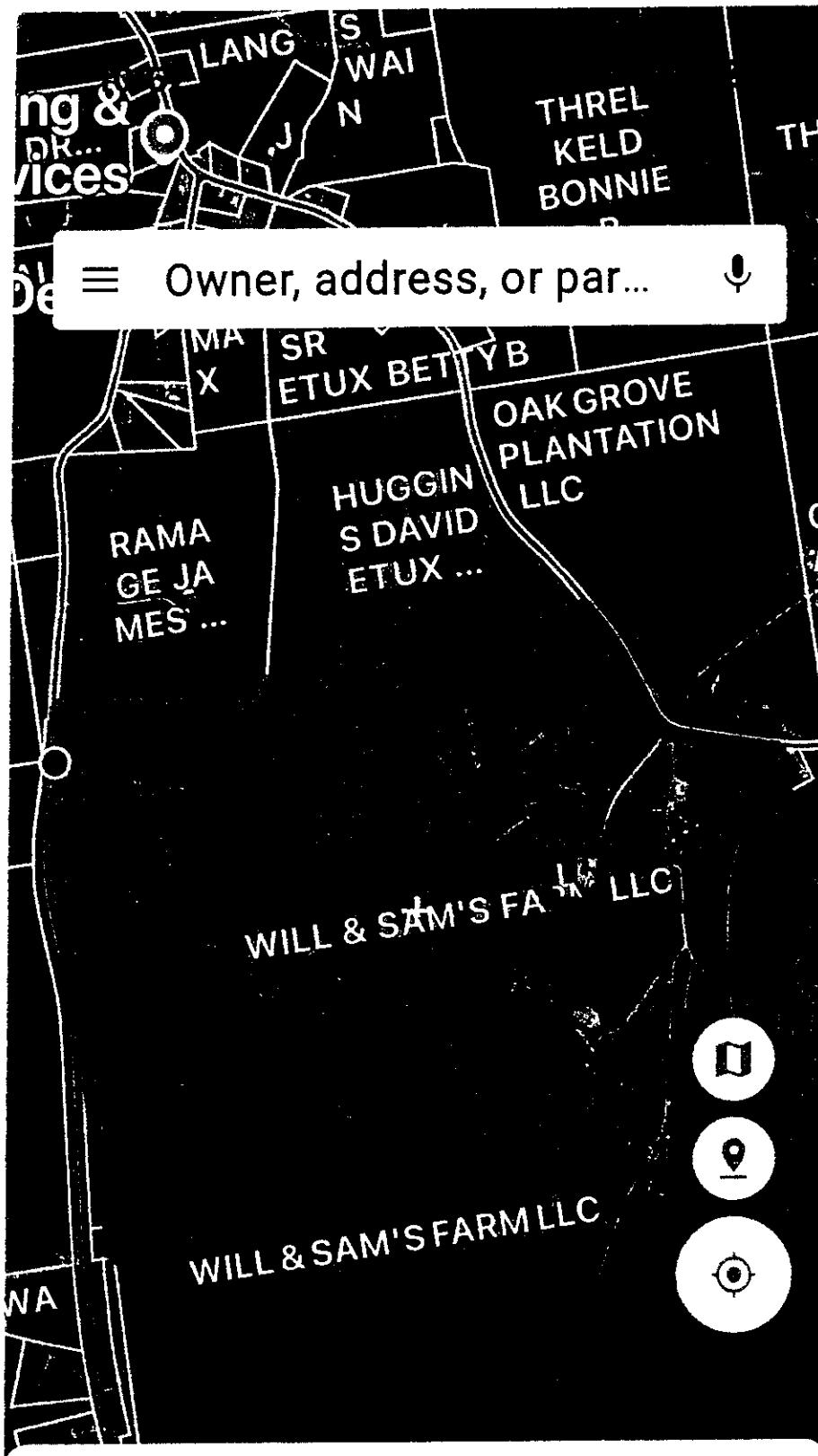

**WILL & SAM'S FARM LLC**

Owner

0

Address

**204 -18-004.00**

Parcel ID

**LAND USE LEASE AGREEMENT**

**Temporary Disposal Site for Vegetative Debris**

This Land Use Lease Agreement ("Agreement") is made and entered into on this 6 day of February, 2026, by and between:

**LESSOR:**

Will & Sam's Farm LLC  
136 CR 423  
Oxford MS 39655

**LESSEE:**

Boys Great Services of MS, Inc.

Highway 13 N

MS 39429

The Lessor is the lawful owner of certain real property located at:

**Legal Description of Property:**

Day - 19 - 004.00

The Lessee desires to temporarily use a portion of said property as a Temporary Disposal Site for Vegetative Debris resulting from Tree Stump, and the Lessor hereby agrees to allow such use subject to the terms of this Agreement.

This Agreement shall commence on Feb 6, 2026, and shall terminate on Feb 6, 2026, unless extended in writing by mutual agreement of the parties.

---

### USE OF PREMISES

The premises shall be used exclusively for the temporary collection, storage, processing (including chipping, grinding, and burning where permitted), and transfer of vegetative waste (including tree limbs, logs, brush, and similar organic materials).

Construction and Demolition debris consisting solely of non-hazardous, inert materials (including untreated wood, concrete, and asphalt) may be collected, stored, processed, and disposed only to the extent permitted by applicable law.

Hazardous waste, household waste, or other prohibited materials shall be accepted or stored on the premises.

---

### COMPENSATION

The Lessee agrees to pay the Lessor:

A flat rate of \$ 0 per month.

At the option of the Lessee, this Agreement may be extended beyond the original termination date on a month-to-month (30-day) basis at a rate of \$ 0 per month for a period of four (4) additional months (120 days), upon written notice to the Lessor.

---

### RESTORATION

At the termination or expiration of this Agreement, the Lessee shall:

Remove all debris and related materials from the premises; and

Restore the premises to a condition substantially the same as existed prior to Lessee's use, including grading and erosion control as reasonably necessary.

---

The Lessor, its agents, and contractors shall have reasonable access to the premises at all times for the purpose of this Agreement, subject to

---

This indemnification shall not apply to the extent such claims are caused by the negligence of Lessee.

Lessee shall not be responsible for damages or liabilities resulting from the natural condition of the land, latent hazards, or any activities not directly under the Lessee's control.

This indemnification shall survive the termination or expiration of this Agreement.

**Lessee's Indemnification of Lessor**

Lessee shall indemnify, defend, and hold harmless the Lessor from and against any and all claims, demands, liabilities, damages, losses, costs, and expenses, including reasonable attorneys' fees, arising out of or related to Lessee's use, possession, or operation of the premises, including claims by third parties and claims by Lessee's employees, agents, or contractors.

This indemnification shall survive the termination or expiration of this Agreement.

---

**10. MISCELLANEOUS**

This Agreement constitutes the entire agreement between the parties and may be amended only in writing signed by both parties.

This Agreement shall be governed by the laws of the State of Mississippi.

---

**WITNESS WHEREOF**

LESSOR: W. W. Larson

LESSOR: W. W. Larson

LESSEE: [Signature]

LESSEE: [Signature]

**PROCLAMATION OF EXISTENCE OF A LOCAL EMERGENCY**  
**Lafayette County Board of Supervisors**

**WHEREAS, the Lafayette County Board of Supervisors** does hereby find that conditions of extreme peril to the safety of persons and property have arisen within Lafayette County, caused by

**Winter Storm**

Commencing on or about 3:00 PM on the 23rd day of January, 2026; and

**WHEREAS, the aforesaid conditions of extreme peril warrant and necessitate the proclamation of the existence of a local emergency in order to provide for the health and safety of the citizens and the protection of their property within the affected jurisdiction;**

**NOW, THEREFORE, IT IS HEREBY PROCLAIMED** that in accordance with Section 33-15-17(d), Mississippi Code of 1972, as amended, a local emergency now exists throughout **Lafayette County**; and shall be reviewed every thirty (30) days until such local emergency is no longer in effect and proclaimed terminated by the **Lafayette County Board of Supervisors**, State of Mississippi.

**IT IS FURTHER PROCLAIMED AND ORDERED** that all **Lafayette County** agencies and departments shall render all possible assistance and discharge their emergency responsibilities as set forth in the Lafayette County Emergency Operations Plan.

DATE: 1-23-26

Brent Larson

President, Board of Supervisors

ATTEST:

[Signature]  
Clerk for Board of Supervisors

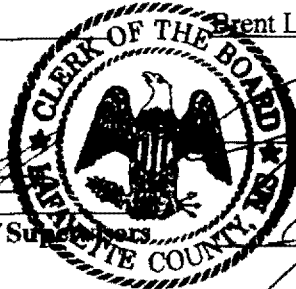

[Signature]  
Supervisor

[Signature]  
Supervisor

[Signature]  
Supervisor

[Signature]  
Supervisor

**Lafayette County, State of MS**