

**ORDER: APPROVE COUNTY FORCES ENTERING PRIVATE PROPERTY TO  
TEMPORARILY OPEN AN ABANDONED PORTION OF COUNTY ROAD 308 AS A  
DETOUR TO THE TRANSFER STATION**

Motion was made by Scott Allen, duly seconded by Tim Gordon, to approve County forces entering private property to temporarily open an abandoned portion of County Road 308 as a detour to the Transfer Station.

The vote on the motion was as follows:

Supervisor Brent Larson, voted yes  
Supervisor John Morgan, absent  
Supervisor Tim Gordon, voted yes  
Supervisor Scott Allen, voted yes  
Supervisor Greg Bynum, voted yes

After the vote, President Larson, declared the motion carried, this the 5<sup>th</sup> day of January, 2026.

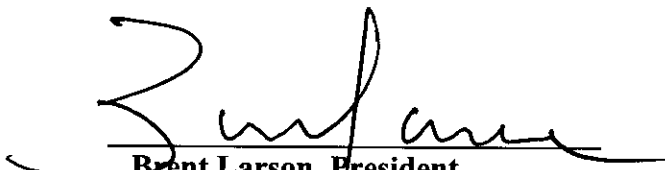
  
Brent Larson, President  
Board of Supervisors

  
Mike Roberts, Chancery Clerk

# Lafayette County MS

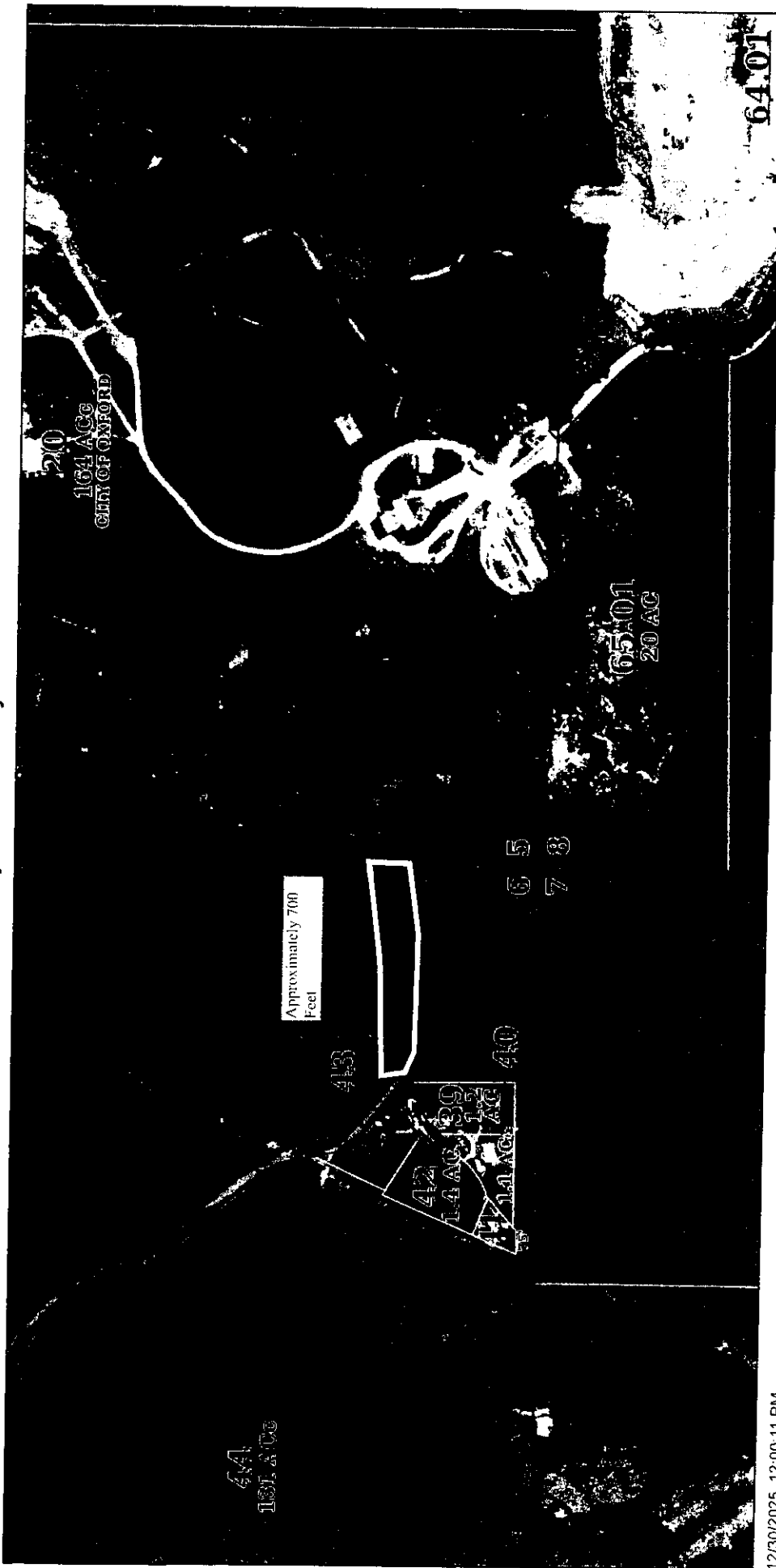

12/30/2025, 12:00:11 PM

- Roads and Railroads  SectionLine
- 2  Parcels
- LandHook  Lafayette\_ms\_water
- Leader  Lafayette\_ms\_twrprng

- lafayette\_ms\_subref
- lafayette\_ms\_secno
- lafayette\_ms\_rname
- lafayette\_ms\_roadname
- lafayette\_ms\_parno
- lafayette\_ms\_misc
- lafayette\_ms\_loino
- lafayette\_ms\_exempt
- lafayette\_ms\_dist
- lafayette\_ms\_dim
- lafayette\_ms\_citylim
- lafayette\_ms\_ac

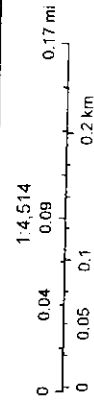

Esri, HERE, Garmin, (c) OpenStreetMap contributors, and the GIS User Community, Esri, HERE, Garmin, GeoTechnologies, Inc., USGS, EPA