

**ORDER: ACCEPT THE C-STORE HWY 6 WEST PRELIMINARY AND FINAL SITE  
PLAN CONTINGENT UPON APPROVAL FROM THE HEALTH DEPARTMENT FOR  
THE ON-SITE WASTEWATER SYSTEM**

Motion was made by Tim Gordon, duly seconded by John Morgan, to accept the C-Store Hwy 6 West Preliminary and Final Site Plan contingent upon approval from the Health Department for the on-site wastewater system.

The vote on the motion was as follows:

Supervisor Brent Larson, voted yes  
Supervisor John Morgan, voted yes  
Supervisor Tim Gordon, voted yes  
Supervisor Scott Allen, voted yes  
Supervisor Greg Bynum, voted yes

After the vote, President Larson, declared the motion carried, this the 1<sup>st</sup> day of April, 2024.

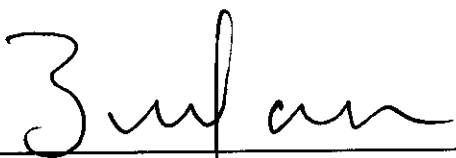

**Brent Larson, President  
Board of Supervisors**

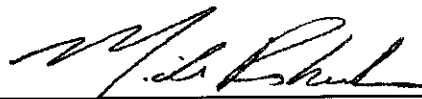

**Mike Roberts, Chancery Clerk**

## **Kate Victor**

---

**From:** Joel Hollowell  
**Sent:** Thursday, March 28, 2024 12:49 PM  
**To:** Brent Larson; Greg Bynum; John Morgan; Scott Allen; Tim Gordon  
**Cc:** Kate Victor; David O'Donnell (DODonnell@ClaytonODonnell.Com)  
**Subject:** Development Services agenda item

Everyone:

There's only one Development Services item on Monday's agenda. Please see my comments below and let me know if you have any questions.

Have a great Easter!

Thanks,

Joel

### **(District 3) C Store Hwy 6 West final site plan**

This convenience store is proposed for Lafayette County parcels 148-28-032, 148-28-033, and 148-28-034 at the intersection of Hwy 6 W and CR 105. This proposal received conditional use permit approval from the Board of Supervisors on November 20, 2023. The developer has returned seeking final site plan approval.

The proposed site plan conforms to the conceptual plan that was presented during the conditional use permit process and is compliant with the provisions of the conditional use permit and the Lafayette County Zoning Ordinance. The site plan application also meets the requirements of the Lafayette County Land Development Standards and Regulations with the exception of the developer has not received final approval from the Health Department for the on-site wastewater system. Approvals from the Health Department for commercial entities have been backlogged recently. Lafayette County experienced the same issue with our addition to Central Fire Station.

The Planning Commission recommends final site plan approval with a safeguard that the Building Department will withhold the certificate of occupancy until Health Department approval of the wastewater system.

# CONSTRUCTION PLANS FOR: C-STORE Highway 6 West

Lafayette County, Mississippi

## INDEX OF DRAWINGS

Sheet #	Sheet Name
C0.0	COVER
C1.0	EXISTING CONDITIONS
C2.0	SITE LAYOUT
C2.01	SITE LAYOUT VEH. TRACK
C2.1	IMPERVIOUS AREAS
C3.0	UTILITY LAYOUT
C3.1	STORM SEWER LAYOUT
C4.0	GRADING PLAN
C5.0	EROSION CONTROL PLAN
C6.0	LIGHTING & SIGNAGE PLAN
C7.0	LANDSCAPE PLAN
C8.0	ELEVATION & FLOOR PLAN
C10.0	SITE DETAILS
C10.1	SITE DETAILS (CONTD)
C10.2	WATER DETAILS
C10.3	SEWER DETAILS
C10.4	STORM SEWER DETAILS
C10.5	EROSION CONTROL DETAILS

## LOCATION MAP

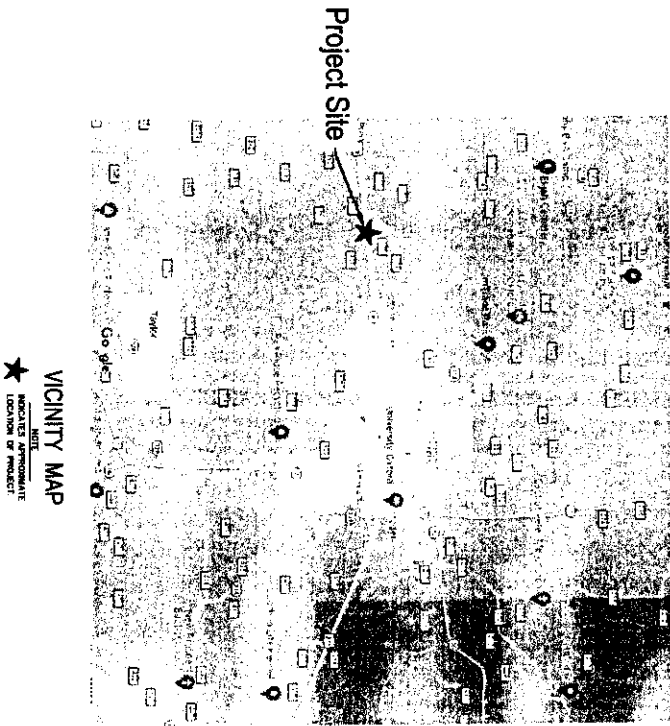
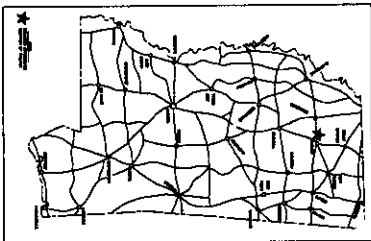

VICINITY MAP  
NOTE:  
★ INDICATES PROJECT  
LOCATION OF PROJECT

























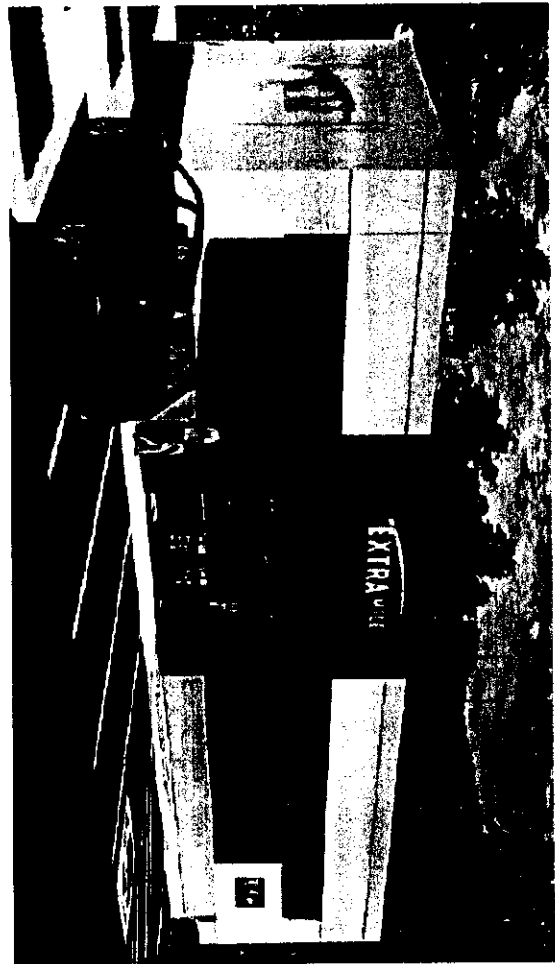

Store Monument Sign

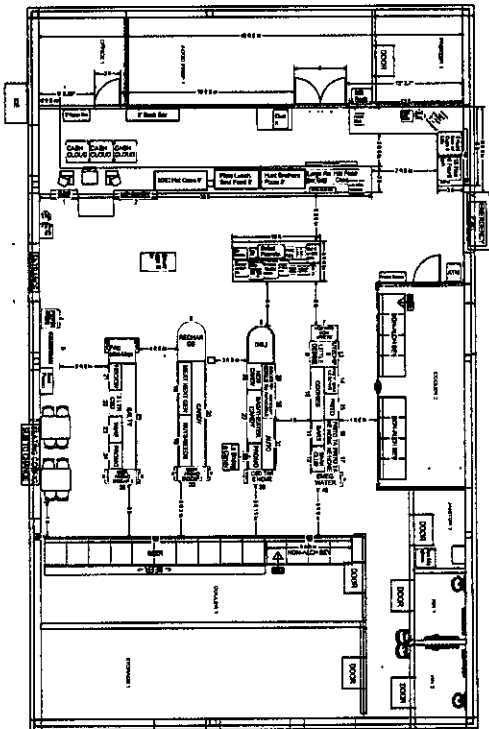

Building Floorplan

REVISION	DATE
1	1-1-88
2	1-1-88
3	1-1-88
4	1-1-88
5	1-1-88
6	1-1-88
7	1-1-88
8	1-1-88
9	1-1-88
10	1-1-88
11	1-1-88
12	1-1-88
13	1-1-88
14	1-1-88
15	1-1-88
16	1-1-88
17	1-1-88
18	1-1-88
19	1-1-88
20	1-1-88
21	1-1-88
22	1-1-88
23	1-1-88
24	1-1-88
25	1-1-88
26	1-1-88
27	1-1-88
28	1-1-88
29	1-1-88
30	1-1-88
31	1-1-88
32	1-1-88
33	1-1-88
34	1-1-88
35	1-1-88
36	1-1-88
37	1-1-88
38	1-1-88
39	1-1-88
40	1-1-88
41	1-1-88
42	1-1-88
43	1-1-88
44	1-1-88
45	1-1-88
46	1-1-88
47	1-1-88
48	1-1-88
49	1-1-88
50	1-1-88
51	1-1-88
52	1-1-88
53	1-1-88
54	1-1-88
55	1-1-88
56	1-1-88
57	1-1-88
58	1-1-88
59	1-1-88
60	1-1-88
61	1-1-88
62	1-1-88
63	1-1-88
64	1-1-88
65	1-1-88
66	1-1-88
67	1-1-88
68	1-1-88
69	1-1-88
70	1-1-88
71	1-1-88
72	1-1-88
73	1-1-88
74	1-1-88
75	1-1-88
76	1-1-88
77	1-1-88
78	1-1-88
79	1-1-88
80	1-1-88
81	1-1-88
82	1-1-88
83	1-1-88
84	1-1-88
85	1-1-88
86	1-1-88
87	1-1-88
88	1-1-88
89	1-1-88
90	1-1-88
91	1-1-88
92	1-1-88
93	1-1-88
94	1-1-88
95	1-1-88
96	1-1-88
97	1-1-88
98	1-1-88
99	1-1-88
100	1-1-88

