

REQUEST FOR THEORA HAMBLETT SIGN IN PARIS. NO ACTION WAS TAKEN

**ORDER: APPROVE VACATING OF FILED CONDOMINIUM PLAT FOR
PHASE 1 OF LOT 1 OXFORD FARMS PHASE SEVEN**

Motion was made by David Rikard, duly seconded by Brent Larson, to approve vacating of filed condominium plat for Phase 1 of Lot 1 Oxford Farms Phase 7.

The vote on the motion was as follows:

Supervisor Brent Larson, voted yes
Supervisor Larry Gillespie, voted yes
Supervisor David Rikard, voted yes
Supervisor Chad McLarty, voted yes
Supervisor Mike Roberts, voted yes

After the vote, President Roberts, declared the motion carried, this the 17th day of May, 2021.



Mike Roberts, President
Board of Supervisors



Sherry Wall, Chancery Clerk

Lisa Carwyle

From: Joey Moore <jmoore@williamsec.com>
Sent: Wednesday, May 12, 2021 9:54 AM
To: Lisa Carwyle
Subject: Vacated Plat Condominium Plat - Phase 1 of Lot 1 Oxford Farms, Phase 7
Attachments: U0800486.PDF

Lisa,

We need to get on the agenda for Monday to vacate the filed condominium plat for Phase 1 of Lot 1 Oxford Farms, Phase 7 (attached) so we can refile a new one with the correct Condominium name listed (Phase 1 of Plat for Stillwater Condominiums).

Please let me know if you have any further questions.

Thank you,



Joey Moore, PE.
Williams Engineering Consultants, Inc.
P.O. Box 1197
720 North Lamar Boulevard
Oxford, MS 38655
Office 662-236-9675
Fax 662-236-9677
Please visit our website at Williamsec.com

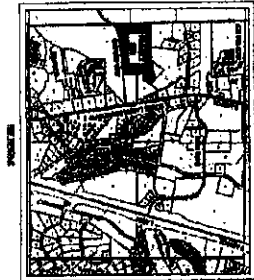
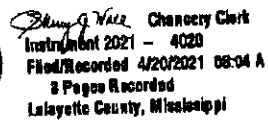

1
2
3
4
5
6
7
8
9
10
11
12
13
14
15
16
17
18
19
20
21
22
23
24
25
26
27
28
29
30
31
32
33
34
35
36
37
38
39
40
41
42
43
44
45
46
47
48
49
50
51
52
53
54
55
56
57
58
59
60
61
62
63
64
65
66
67
68
69
70
71
72
73
74
75
76
77
78
79
80
81
82
83
84
85
86
87
88
89
90
91
92
93
94
95
96
97
98
99
100

SECRET

[illegible]

LEGEND



183

Contributions
Plus

Condominium Plat For:
Phase 1 of Lot 1 Odors Farms, Phase 7
A tract of land being a fraction of the West Half
(W 1/2) of Section 33, Township 8 South, Range 3 West,
City of Odors, Lafayette County, Mississippi



WILLIAMS ENGINEERING CONSULTANTS, INC.
Professional Engineers | Professional Land Surveyors

720-677-1444 (Toll-Free)
P.O. Box 1000, Chicago, Illinois 60601-1000
(312) 321-3900

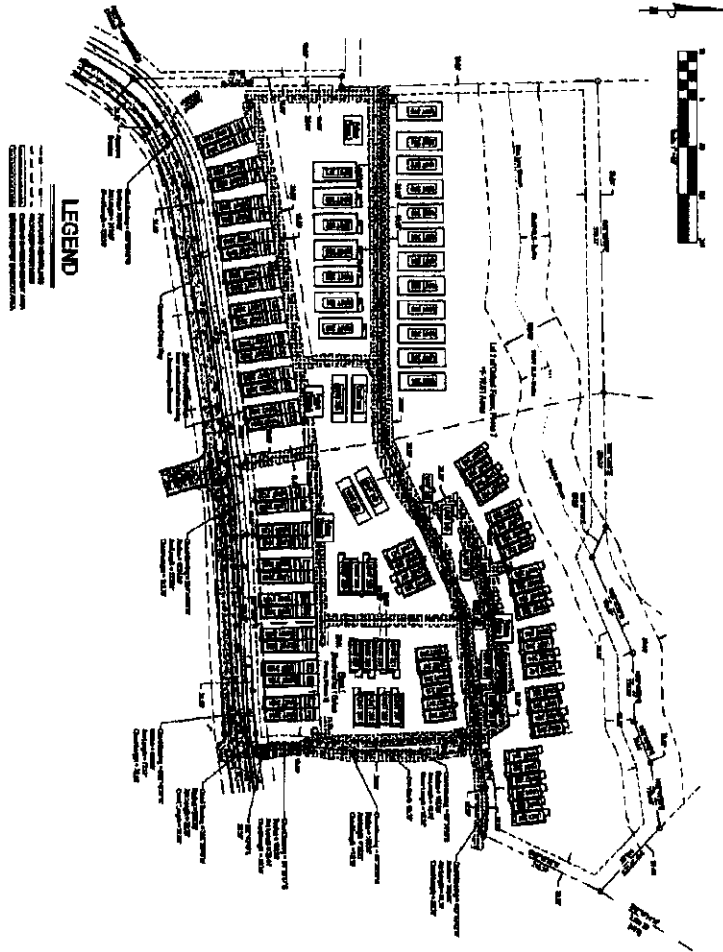

THESE PLANS WERE PREPARED BY WILLIAMS ENGINEERING CONSULTANTS, INC. FOR THE PROJECT DESCRIBED HEREIN. THE ENGINEER'S RESPONSIBILITY IS LIMITED TO THE DESIGN AND CONSTRUCTION OF THE PROJECT DESCRIBED HEREIN. THE ENGINEER DOES NOT WARRANT THE ACCURACY OF THE INFORMATION PROVIDED HEREON. THE ENGINEER'S LIABILITY IS LIMITED TO THE DESIGN AND CONSTRUCTION OF THE PROJECT DESCRIBED HEREIN. THE ENGINEER DOES NOT WARRANT THE ACCURACY OF THE INFORMATION PROVIDED HEREON. THE ENGINEER'S LIABILITY IS LIMITED TO THE DESIGN AND CONSTRUCTION OF THE PROJECT DESCRIBED HEREIN. THE ENGINEER DOES NOT WARRANT THE ACCURACY OF THE INFORMATION PROVIDED HEREON.

[Signatures and Professional Seals]

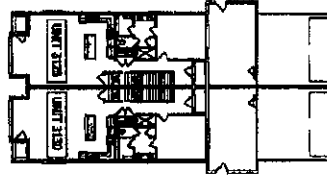

UNITS 3128 - 3130

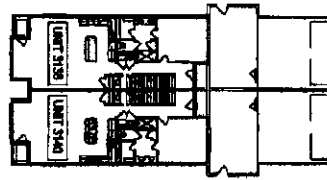

UNITS 3138 - 3140

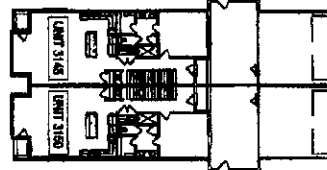

UNITS 3148 - 3150

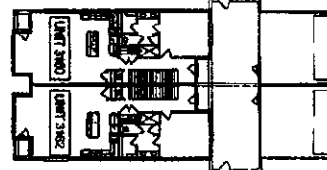

UNITS 3168 - 3169

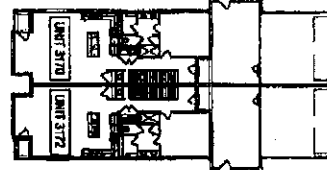

UNITS 3178 - 3179

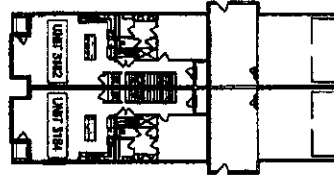

UNITS 3182 - 3184

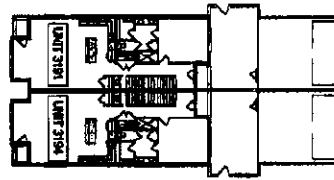

UNITS 3191 - 3194

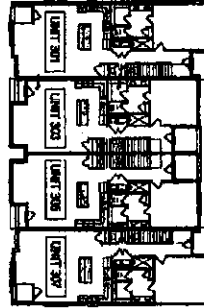

UNITS 321 - 327

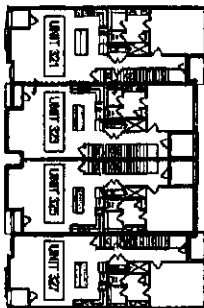

UNITS 321 - 327

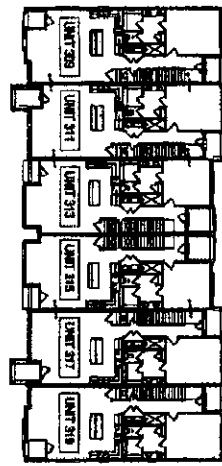

UNITS 329 - 339

Condominium Plat For:
Phase 1 of Lot 1 Oxford Farms, Phase 7
A tract of land being a Section of the West Half
(W 1/2) of Section 33, Township 8 South, Range 3 West,
City of Oxford, Lafayette County, Minnesota



WILLIAMS ENGINEERING CONSULTANTS, INC.
Professional Engineers Professional Land Surveyors

Professional Surveyors License No. 10000
Professional Engineers License No. 10000
P.O. Box 10000, Oxford, Minnesota 56455

Unit	Area	Volume	Weight	Value
1	100	100	100	100
2	100	100	100	100
3	100	100	100	100
4	100	100	100	100
5	100	100	100	100
6	100	100	100	100
7	100	100	100	100
8	100	100	100	100
9	100	100	100	100
10	100	100	100	100

Condominium
Plat