

ORDER: AUTHORIZE CONDITIONAL USE AT WELLINGTON PLACE

Motion was made by David Rikard, duly seconded by Kevin Frye, to authorize conditional use at Wellington Place.

The vote on the motion was as follows:

Supervisor Kevin Frye, voted yes
Supervisor Jeff Busby, voted yes
Supervisor David Rikard, voted yes
Supervisor Chad McLarty, voted yes
Supervisor Mike Roberts, voted yes

After the vote, President Busby, declared the motion carried, this the 4th day of September, 2018.



Jeff Busby, President
Board of Supervisors

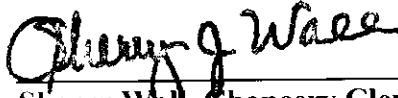

Sherry Wall, Chancery Clerk

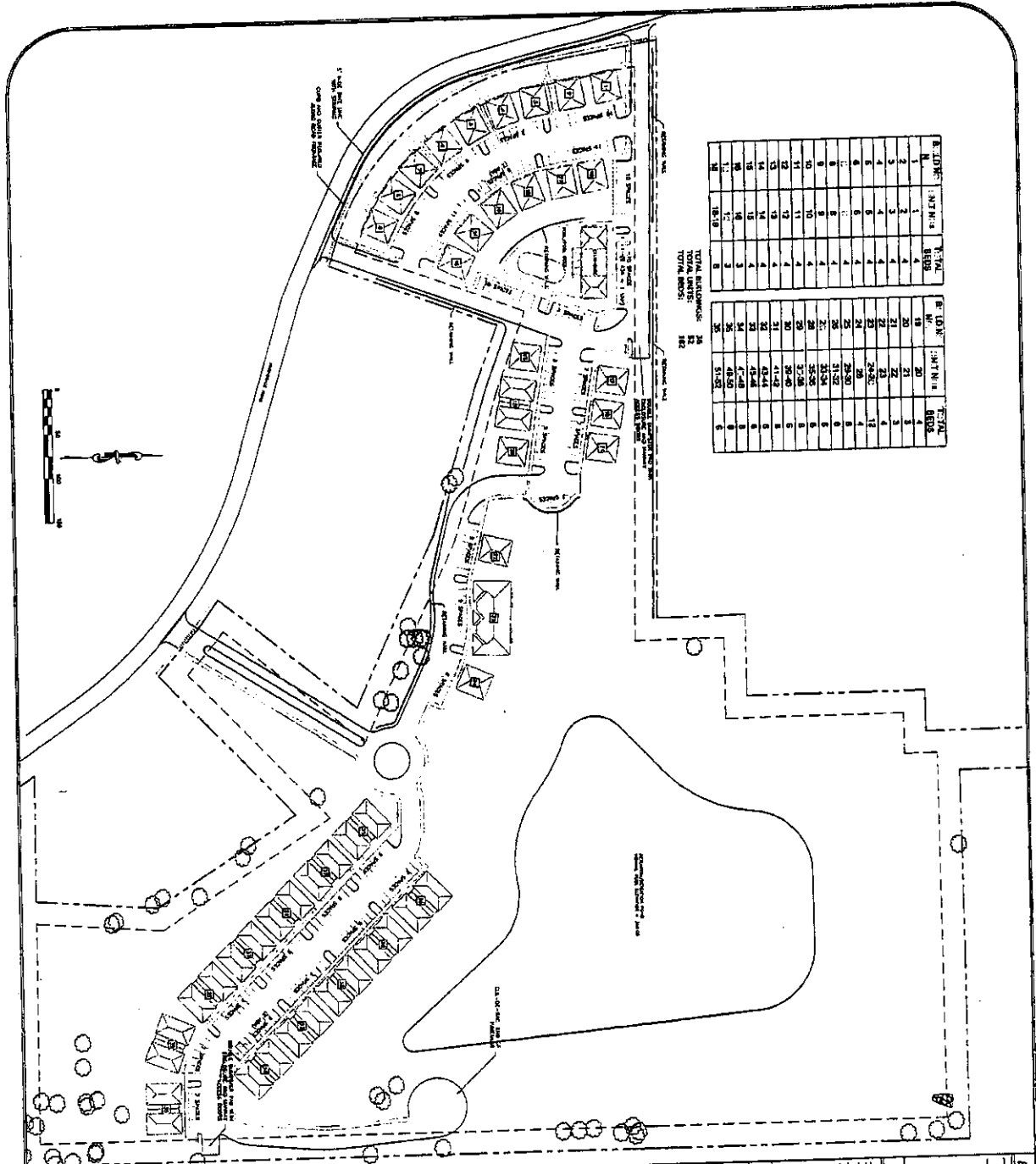

NO.	AREA	AREA	AREA
1	1	1	1
2	2	2	2
3	3	3	3
4	4	4	4
5	5	5	5
6	6	6	6
7	7	7	7
8	8	8	8
9	9	9	9
10	10	10	10
11	11	11	11
12	12	12	12
13	13	13	13
14	14	14	14
15	15	15	15
16	16	16	16
17	17	17	17
18	18	18	18
19	19	19	19
20	20	20	20
21	21	21	21
22	22	22	22
23	23	23	23
24	24	24	24
25	25	25	25
26	26	26	26
27	27	27	27
28	28	28	28
29	29	29	29
30	30	30	30
31	31	31	31
32	32	32	32
33	33	33	33
34	34	34	34
35	35	35	35
36	36	36	36
37	37	37	37
38	38	38	38
39	39	39	39
40	40	40	40
41	41	41	41
42	42	42	42
43	43	43	43
44	44	44	44
45	45	45	45
46	46	46	46
47	47	47	47
48	48	48	48
49	49	49	49
50	50	50	50
51	51	51	51
52	52	52	52
53	53	53	53
54	54	54	54
55	55	55	55
56	56	56	56
57	57	57	57
58	58	58	58
59	59	59	59
60	60	60	60
61	61	61	61
62	62	62	62
63	63	63	63
64	64	64	64
65	65	65	65
66	66	66	66
67	67	67	67
68	68	68	68
69	69	69	69
70	70	70	70
71	71	71	71
72	72	72	72
73	73	73	73
74	74	74	74
75	75	75	75
76	76	76	76
77	77	77	77
78	78	78	78
79	79	79	79
80	80	80	80
81	81	81	81
82	82	82	82
83	83	83	83
84	84	84	84
85	85	85	85
86	86	86	86
87	87	87	87
88	88	88	88
89	89	89	89
90	90	90	90
91	91	91	91
92	92	92	92
93	93	93	93
94	94	94	94
95	95	95	95
96	96	96	96
97	97	97	97
98	98	98	98
99	99	99	99
100	100	100	100

TOTAL BUILDINGS: 32
TOTAL LOTS: 32
TOTAL ACRES: 1.02

EXISTING CONDITIONS LEGEND

Legend for existing conditions:
 - Building Footprint: Solid black line
 - Parking Area: Dashed line
 - Road: Solid line
 - Open Area: White space
 - Tree: Circle with crosshairs
 - Utility Pole: Circle with dot
 - Fence: Dashed line with crosshairs
 - Water Body: Blue area
 - Topography: Contour lines

SITE LAYOUT LEGEND

Legend for site layout:
 - Proposed Building Footprint: Solid black line
 - Proposed Parking Area: Dashed line
 - Proposed Road: Solid line
 - Proposed Open Area: White space
 - Proposed Tree: Circle with crosshairs
 - Proposed Utility Pole: Circle with dot
 - Proposed Fence: Dashed line with crosshairs
 - Proposed Water Body: Blue area
 - Proposed Topography: Contour lines

GENERAL ABBREVIATIONS

Abbreviations used in the plan:
 - Bldg: Building
 - Pkng: Parking
 - Rd: Road
 - Open: Open Area
 - Tree: Tree
 - Pole: Utility Pole
 - Fence: Fence
 - Water: Water Body
 - Topo: Topography

PLAN NOTES

Notes for the plan:
 1. All dimensions are in feet.
 2. All areas are in square feet.
 3. All distances are in feet.
 4. All bearings are in degrees, minutes, and seconds.

KEYNOTES

Keynotes for the plan:
 - 1: Building Footprint
 - 2: Parking Area
 - 3: Road
 - 4: Open Area
 - 5: Tree
 - 6: Utility Pole
 - 7: Fence
 - 8: Water Body
 - 9: Topography

SITE DATA

Site data:
 - Project Name: Wellington Place
 - Location: [Address]
 - Owner: [Name]
 - Date: [Date]

Additional site data:
 - Zoning: [Zoning Code]
 - Lot Area: [Area]
 - Building Area: [Area]
 - Parking Area: [Area]

Notes for the site data:
 - All dimensions are in feet.
 - All areas are in square feet.
 - All distances are in feet.
 - All bearings are in degrees, minutes, and seconds.



NO.	REVISIONS	DATE
1	Initial Design	10/1/2020
2	Revised Design	10/15/2020
3	Final Design	10/30/2020
4	As-Built	11/10/2020
5	Final As-Built	11/20/2020

OVERALL SITE LAYOUT FOR WELLINGTON PLACE AMENDED

C101