

**ORDER: ACCEPT PLANNING COMMISSION RECOMMENDATION TO  
APPROVE PRELIMINARY COMMERCIAL PLAT FOR OLD OAKS  
SUBDIVISION**

Motion was made by Chad McLarty, duly seconded by Mike Roberts, to accept the Planning Commission recommendation to approve Preliminary Commercial Plat for Old Oaks Subdivision.

The vote on the motion was as follows:

Supervisor Kevin Frye, voted yes  
Supervisor Jeff Busby, voted yes  
Supervisor David Rikard, voted no  
Supervisor Chad McLarty, voted yes  
Supervisor Mike Roberts, voted yes

After the vote, President Busby, declared the motion carried, this the 5th day of July, 2017.

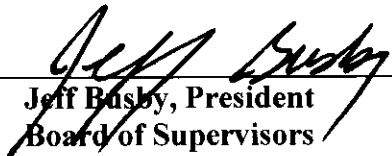
  
\_\_\_\_\_  
Jeff Busby, President  
Board of Supervisors

  
\_\_\_\_\_  
Sherry Wall, Clerical Clerk

X Preliminary

## Final

**Lafayette County Subdivision Regulations (Revision 2015-1)**

Geotechnical Engineering  
Hydraulic Engineering  
Civil Engineering  
Surveying

276 County Road 101  
Oxford, MS 38655  
[oxford@pecorpms.com](mailto:oxford@pecorpms.com)



Land Planning/Subdivisions  
Road and Bridge Design  
Utility System Design  
Materials Testing

Phone 662-234-8539  
Fax 662-234-8639  
[www.pecorpms.com](http://www.pecorpms.com)

June 22, 2017

Mr. Larry Britt, P.E.  
Lafayette County Planning Commission  
P.O. Box 308  
Oxford, MS 38655

RE: OLD OAKS of OXFORD – Revised Schematic Drawing

Dear Mr. Britt,

The following changes have been made to the Schematic Drawing of CR 238 – Sheet C011.

- The northern entrance, which is also the intersection of Post Oak Drive and CR 217, will be a 3 Way-Stop with approach warning lights and rumble strips.
- The northern intersection of CR 217 and CR 238 will be a 3 Way-Stop with approach warning lights and rumble strips.
- The portion of CR 238 that was to be abandoned shall remain operational.
- CR 238 improvements shall be made so that it will better accommodate 2-way traffic.
- The entrance at Campground Road will be improved so that it will accommodate emergency vehicles. (All improvements are to be on the east side of existing road.
- Live Oak Drive will not be extended to CR 217.
- A "Gated Future Access" has been added at the southeast corner of the project to the Cul-de-sac on Nuttall Oak Drive.

Please let us know if you have any questions.

Sincerely,

Paul Koshenina, P.E

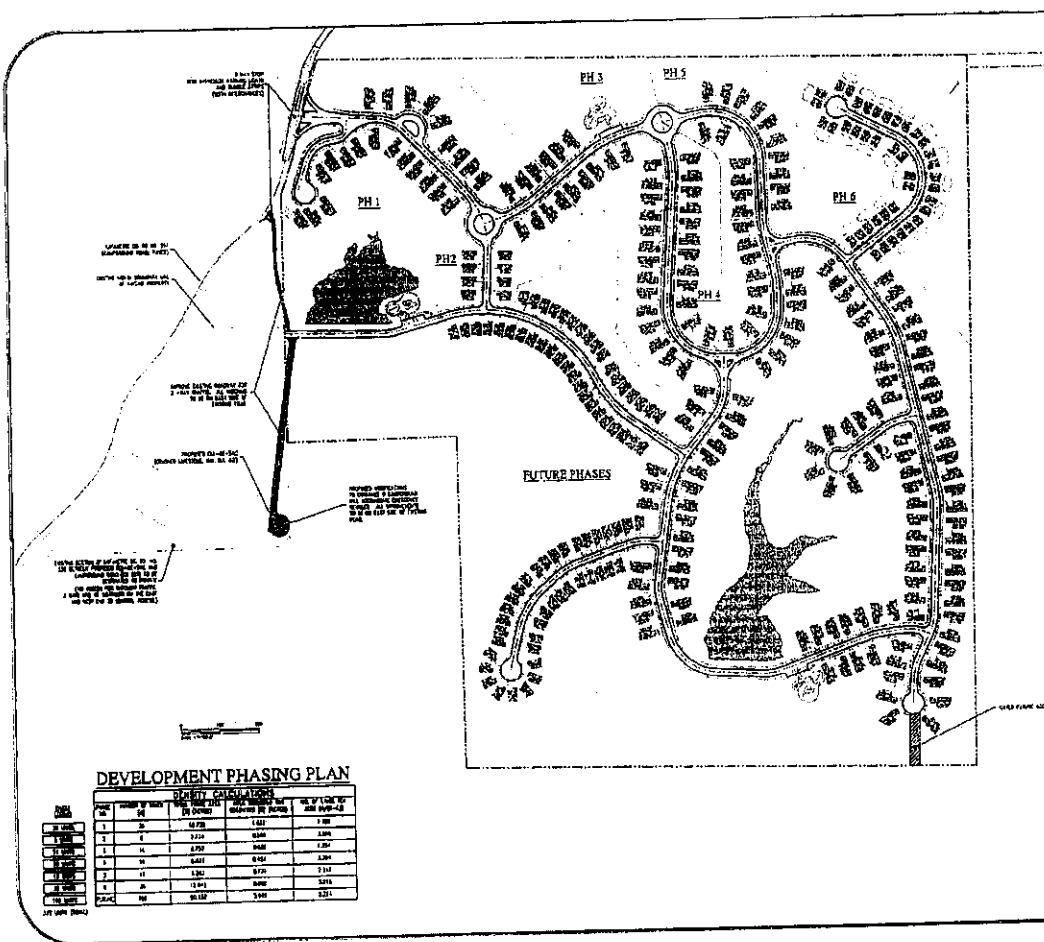

REVISIONS

SCHEMATIC of CR 238  
MODIFICATIONS

FOR  
OLD OAKS of OXFORD

(a WALKER & WALKER ENTERPRISES, LLC development)

C011