

**ORDER: ACCEPT PLANNING COMMISSION'S
RECOMMENDATION TO APPROVE PRELIMINARY AND FINAL
COMMERCIAL PLAT FOR THE OXFORD CENTRE, PHASE II**

Motion was made by Chad McLarty, duly seconded by Mike Roberts, to accept Planning Commission's recommendation to approve Preliminary and Final Commercial Plat for The Oxford Centre, Phase II.

The vote on the motion was as follows:

Supervisor Kevin Frye, voted yes
Supervisor Jeff Busby, voted yes
Supervisor David Rikard, voted yes
Supervisor Chad McLarty, voted yes
Supervisor Mike Roberts, voted yes

After the vote, President Busby, declared the motion carried, this the 1st day of February, 2016.

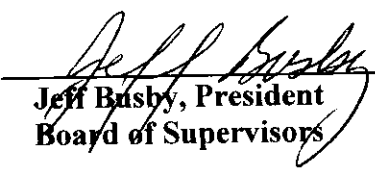
Jeff Busby, President
Board of Supervisors

Sherry Wall, Chancery Clerk

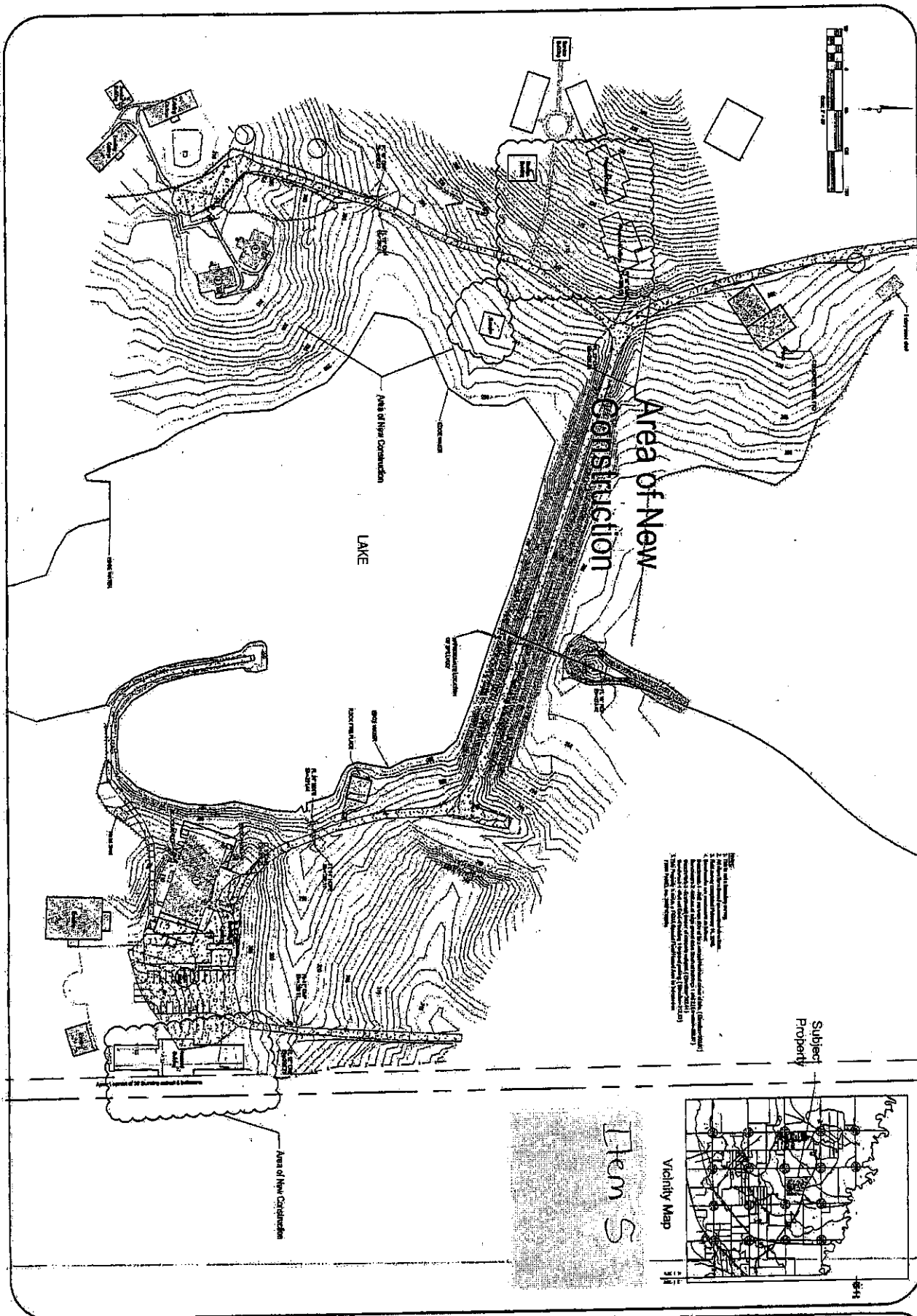

REVISION	DATE
1	10/1/01
2	10/1/01
3	10/1/01
4	10/1/01
5	10/1/01
6	10/1/01
7	10/1/01
8	10/1/01
9	10/1/01
10	10/1/01
11	10/1/01
12	10/1/01
13	10/1/01
14	10/1/01
15	10/1/01
16	10/1/01
17	10/1/01
18	10/1/01
19	10/1/01
20	10/1/01
21	10/1/01
22	10/1/01
23	10/1/01
24	10/1/01
25	10/1/01
26	10/1/01
27	10/1/01
28	10/1/01
29	10/1/01
30	10/1/01
31	10/1/01
32	10/1/01
33	10/1/01
34	10/1/01
35	10/1/01
36	10/1/01
37	10/1/01
38	10/1/01
39	10/1/01
40	10/1/01
41	10/1/01
42	10/1/01
43	10/1/01
44	10/1/01
45	10/1/01
46	10/1/01
47	10/1/01
48	10/1/01
49	10/1/01
50	10/1/01
51	10/1/01
52	10/1/01
53	10/1/01
54	10/1/01
55	10/1/01
56	10/1/01
57	10/1/01
58	10/1/01
59	10/1/01
60	10/1/01
61	10/1/01
62	10/1/01
63	10/1/01
64	10/1/01
65	10/1/01
66	10/1/01
67	10/1/01
68	10/1/01
69	10/1/01
70	10/1/01
71	10/1/01
72	10/1/01
73	10/1/01
74	10/1/01
75	10/1/01
76	10/1/01
77	10/1/01
78	10/1/01
79	10/1/01
80	10/1/01
81	10/1/01
82	10/1/01
83	10/1/01
84	10/1/01
85	10/1/01
86	10/1/01
87	10/1/01
88	10/1/01
89	10/1/01
90	10/1/01
91	10/1/01
92	10/1/01
93	10/1/01
94	10/1/01
95	10/1/01
96	10/1/01
97	10/1/01
98	10/1/01
99	10/1/01
100	10/1/01

Site layout
 OXFORD CENTRE
 297 County Road 244, Etta, Mississippi, 38627
 Lafayette County, Mississippi



WILLIAMS ENGINEERING CONSULTANTS, INC.
 Professional Engineers | Professional Land Surveyors

701 NORTH LAMAR BLVD., SUITE 100
 HOUSTON, TEXAS 77002-1000
 (713) 861-1000
 FAX (713) 861-1001
 WWW.WILLIAMS-ENGINEERING.COM

12/8/15

